



DIRECT-TEMP®

Metalbestos® Direct Vent System

Includes 5x8 and co-linear

*Direct-Temp® sets the standard
with our New Laser Precision
Designed Direct Vent System.*

Featuring:

- Siliconized fiberglass seal
- 304 stainless welded seam inner flue
- LockTab® security
- Pipe rotates easily to align system components
- Quick no-sealant needed installation
- High efficiency performance



THE BEST DIRECT VENT LIFETIME WARRANTY IN THE INDUSTRY!

Direct-Temp® is Omni, ITS/Warnock Hersey or CSA tested and accepted for use with most major brands of direct vent appliances.



For a complete listing, visit us at www.directtemp.com,
www.selkirkusa.com or www.selkirkcanada.com



SETTING THE STANDARD FOR DIRECT VENT SYSTEMS



Solid relationships are built on integrity, performance and trust. Selkirk® has now developed the Direct-Temp® Direct Vent System which sets the standard with our New Laser Precision Construction.

Integrity

Unique to today's market, Direct-Temp® provides exceptional corrosion protection and virtually no leakage due to an inner stainless steel liner. Stainless steel permits precision manufacturing tolerance, ensuring tight seals and added structural integrity of the system. Our liner has a continuously welded seam, which is superior to lock seam designs that may leak.

Performance

Our engineers set out to surpass the performance requirements of the industry with unique features found only in our direct vent system. Direct-Temp® is ideal for both sidewall and conventional through-the-roof venting solutions, and has been engineered for optimum appliance performance.

Trust

Perfecting the design of the Metalbestos Direct-Temp® system is indicative of Selkirk's commitment as the most trusted supplier for over 80 years. Backed by a Limited Lifetime Warranty, exceptional customer service and technologically superior products, Selkirk is the name to trust.

WHAT MAKES THE DIRECT-TEMP® SYSTEM UNIQUE?

Chamfered edges allow for easy slide-together assembly.

Centering brackets are not welded or riveted in place, creating a more attractive outer jacket and a smooth profile. The free-floating inner liner allows the pipe to expand and contract under high temperature, without creating gaps or stress points in the system.

Our proprietary siliconized fiberglass seal adds an extra layer of protection to ensure combustion products won't leak out.

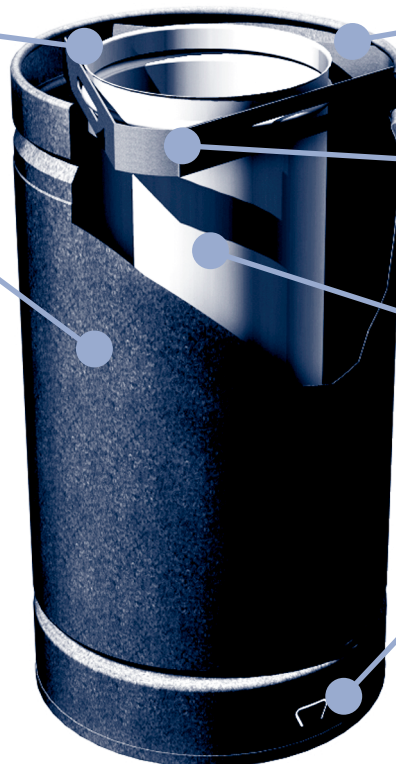
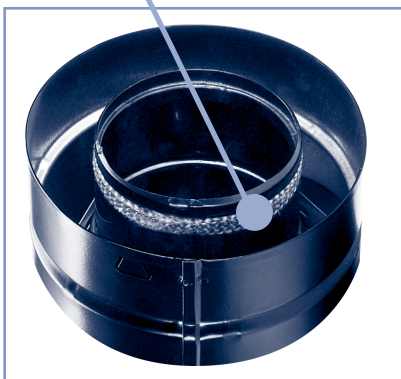

Outer walls are constructed of heavy duty galvanized steel and are available in powder coat black or unpainted versions.

Heavy duty centering brackets keep inner pipe centered for easy assembly. Brackets also allow the inner pipe to float, allowing for expansion and contraction.

The 304 stainless steel seam-welded inner pipe provides exceptional corrosion resistance and enhances overall system integrity.

Our LockTab® is a unique design that allows for 360° rotation while securely locking the sections of pipe together with just a push of the tab.



**ALL BACKED BY THE
BEST WARRANTY IN
THE BUSINESS.**

Parts & Accessories

DIRECT-TEMP® PIPE LENGTH

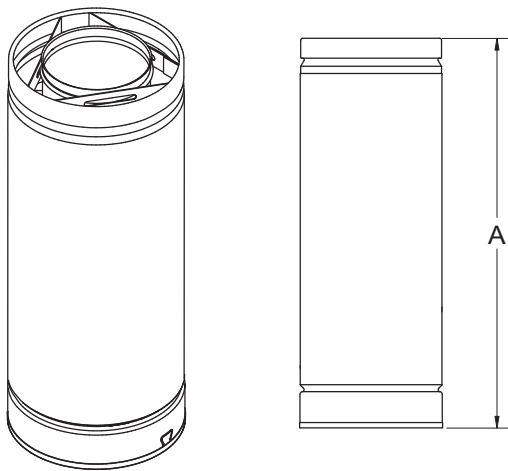

Size	Description	Part #	(A) Lengths	Galvanized	Black	Net Installed Lengths
4 x 6^{5/8}	DT - 6" Pipe	4DT-06	6"	1604006	1604006B	4 3/8"
	DT - 9" Pipe	4DT-09	9"	1604009	1604009B	7 3/8"
	DT - 12" Pipe	4DT-12	12"	1604012	1604012B	10 3/8"
	DT - 18" Pipe	4DT-18	18"	1604018	1604018B	16 3/8"
	DT - 24" Pipe	4DT-24	24"	1604024	1604024B	22 3/8"
	DT - 36" Pipe	4DT-36	36"	1604036	1604036B	34 3/8"
	DT - 48" Pipe	4DT-48	48"	1604048	1604048B	46 3/8"
5 x 8	DT - 6" Pipe	5DT-06	6"	1605006	1605006B	4 3/8"
	DT - 9" Pipe	5DT-09	9"	1605009	1605009B	7 3/8"
	DT - 12" Pipe	5DT-12	12"	1605012	1605012B	10 3/8"
	DT - 18" Pipe	5DT-18	18"	1605018	1605018B	16 3/8"
	DT - 24" Pipe	5DT-24	24"	1605024	1605024B	22 3/8"
	DT - 36" Pipe	5DT-36	36"	1605036	1605036B	34 3/8"
	DT - 48" Pipe	5DT-48	48"	1605048	1605048B	46 3/8"

ADJUSTABLE LENGTH

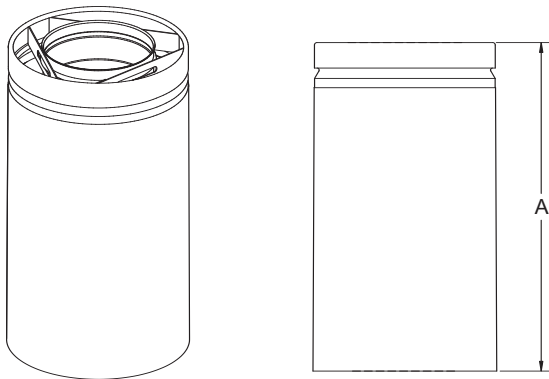

Size	Description	Part #	SKU #
4 x 6^{5/8}	Adjustable Length 4-10" 4 x 6-5/8"	4DT-AJ12	1604082
	Adjustable Length 4-10" 4 x 6-5/8" Black	4DT-AJ12B	1604082B
	Telescopic Adj. Length 14-22" 4 x 6-5/8"	4DT-AJ14	1604084
	Telescopic Adj. Length 14-22" 4 x 6-5/8" Black	4DT-AJ14B	1604084B
5 x 8	Adjustable Length 4-10" 5 x 8"	5DT-AJ12	1605082
	Adjustable Length 4-10" 5 x 8" Black	5DT-AJ12B	1605082B

SIZE	DIM A	DIM A-Telescopic
4 x 6-5/8"	12.0"	14.0"
5 x 8"	12.0"	14.0"

NOTE: Adjustable length slides onto standard pipe section for adjustment from 4" to 10".

APPLIANCE ADAPTER

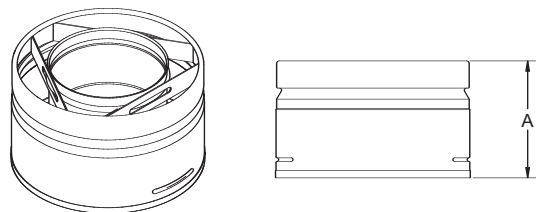

Shown 4DT-AA Appliance Adapter

Size	Description	Part #	SKU #
4 x 6^{5/8}	Appliance Adapter 4 x 6-5/8" Black	4DT-AA	1604245B
	Vermont Castings Adapter 4 x 6-5/8" Black	4DT-AAV	1604246B
	Universal Adapter 4 x 7" Black*	4DT-AAN	1604247B
5 x 8	Appliance Adapter 5 x 8"	5DT-AA	1605245
	Napoleon Fireplace Adapter	5DT-AAN	1605247

SIZE	DIM A
4 x 6-5/8"	4.0"
5 x 8"	4.0"

*For all direct vent appliances with 4x7" outlet, including Napoleon.

NOTE: - 4DT-AA Appliance Adapter can be used to ensure secure connection to twist-lock type appliance outlet collars.

- The Appliance Adapter is not required in every application.

- DIRECT-TEMP WILL SLIDE DIRECTLY ON TO MOST DIRECT VENT APPLIANCE TERMINATIONS.

Touch-up paint - Forrest Stove Brite Satin Black - 1A54H206

Parts & Accessories

VERTICAL TERMINATION

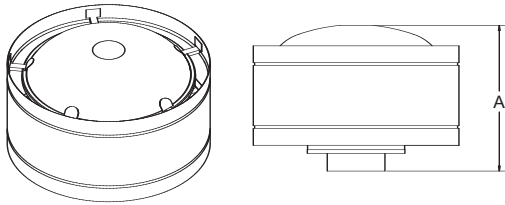

Size	Description	Part #	Sk#
4 x 6⁵/₈	Vertical Termination 4 x 6-5/8"	4DT-VC	1604802
5 x 8	Vertical Termination 5 x 8"	5DT-VC	1605802

SIZE	DIM A
4 x 6-5/8"	10.0"
5 x 8"	10.0"

HORIZONTAL TERMINATION

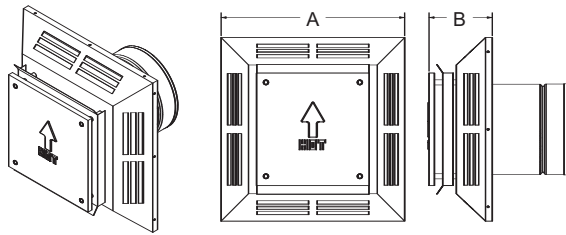

Size	Description	Part #	Sk#
4 x 6⁵/₈	Horizontal Termination 4 x 6-5/8"	4DT-HC	1604804
5 x 8	Horizontal Termination 5 x 8"	5DT-HC	1605804

SIZE	DIM A	DIM B
4 x 6-5/8"	13.50"	7.0"
5 x 8"	16.0"	7.0"

SNORKEL TERMINATION

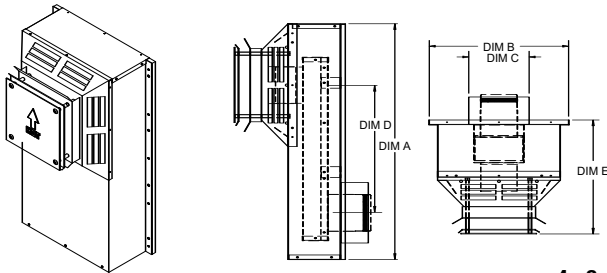

NOTE: Use when horizontal termination is too close to grade or additional height is needed.

Size	Description	Part #	Sk#
4 x 6⁵/₈	14" Rise Snorkel Termination 4 x 6-5/8"	4DT-ST14	1604836
	36" Rise Snorkel Termination 4 x 6-5/8"	4DT-ST36	1604838
5 x 8	14" Rise Snorkel Termination 5 x 8"	5DT-ST14	1605836
	36" Rise Snorkel Termination 5 x 8"	5DT-ST36	1605838

4 x 6⁵/₈

SNORKEL SIZE	DIM A	DIM B	DIM C	DIM D	DIM E
14.0"	26.0"	15.25"	6.63"	14.0"	13.25"
36.0"	48.0"	15.25"	6.63"	36.0"	13.25"

5 x 8

SNORKEL SIZE	DIM A	DIM B	DIM C	DIM D	DIM E
14.0"	27.55"	17.81"	8.04"	14.0"	13.25"
36.0"	49.55"	17.81"	8.04"	36.0"	13.25"

45 DEGREE ELBOW

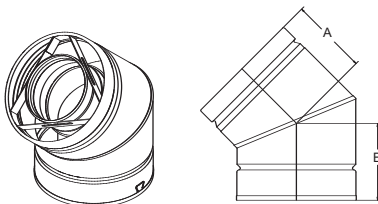

NOTE: 45 degree fixed elbow rotates at the joint connection to properly align installation.

Size	Description	Part #	Sk#
4 x 6⁵/₈	Elbow 4 x 6-5/8" 45 Degrees	4DT-EL45	1604215
	Elbow 4 x 6-5/8" 45 Degrees Black	4DT-EL45(B)	1604215B
5 x 8	Elbow 5 x 8" 45 Degrees	5DT-EL45	1605215
	Elbow 5 x 8" 45 Degrees Black	5DT-EL45(B)	1605215B

SIZE	DIM A	DIM B
4 x 6-5/8"	4.30"	4.30"
5 x 8"	5.00"	5.00"

90 DEGREE ELBOW

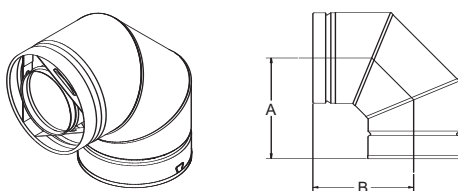

NOTE: 90 degree fixed elbow rotates at the joint connection to properly align installation.

Size	Description	Part #	Sk#
4 x 6⁵/₈	Elbow 4 x 6-5/8" 90 Degrees	4DT-EL90S	1604230S
	Elbow 4 x 6-5/8" 90 Degrees Black	4DT-EL90S(B)	1604230SB
5 x 8	Elbow 5 x 8" 90 Degrees	5DT-EL90	1605230
	Elbow 5 x 8" 90 Degrees Black	5DT-EL90(B)	1605230B

SIZE	DIM A	DIM B
4 x 6-5/8"	6.50"	6.50"
5 x 8"	7.30"	7.30"

Parts & Accessories

ADJUSTABLE ROOF FLASHING 0-12 TO 6-12

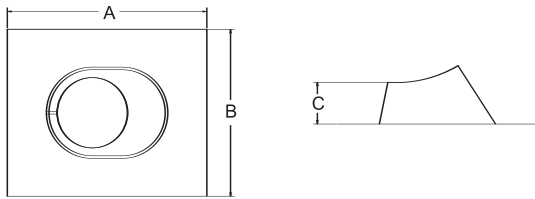

Size	Description	Part #	Sk#
4 x 6⁵/₈	0/12 - 6/12 4 x 6-5/8"	4DT-AF6	1604825
5 x 8	0/12 - 6/12 5 x 8"	5DT-AF6	1605825

SIZE	DIM A	DIM B	DIM C
4 x 6-5/8"	19.125"	16.0"	4.0"
5 x 8"	28.50"	24.00"	4.0"

ADJUSTABLE ROOF FLASHING 6-12 TO 12-12

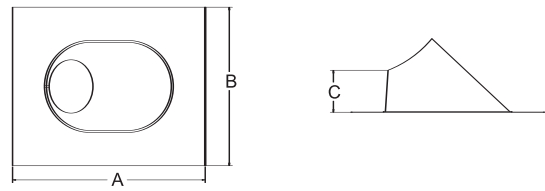

Size	Description	Part #	Sk#
4 x 6⁵/₈	6/12 - 12/12 4 x 6-5/8"	4DT-AF12	1604830
5 x 8	6/12 - 12/12 5 x 8"	5DT-AF12	1605830

SIZE	DIM A	DIM B	DIM C
4 x 6-5/8"	19.125"	16.0"	4.0"
5 x 8"	31.875"	27.0"	4.0"

STORM COLLAR

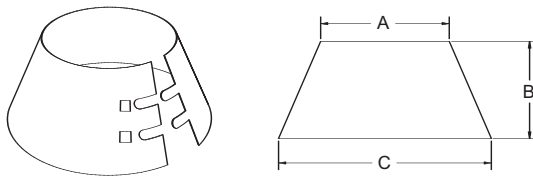

Size	Description	Part #	Sk#
4 x 6⁵/₈	Storm Collar 4 x 6-5/8"	4DT-SC	1604810
5 x 8	Storm Collar 5 x 8"	5DT-SC	1605810

SIZE	DIM A	DIM B	DIM C
4 x 6-5/8"	6.625"	5.50"	11.0"
5 x 8"	8.0"	5.50"	15.0"

CATHEDRAL CEILING SUPPORT BOX

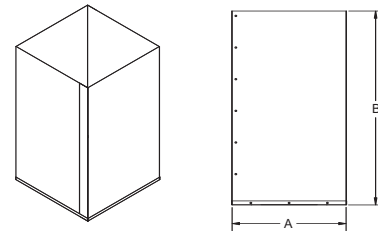

Size	Description	Part #	Sku #
4 x 6 ⁵ / ₈	Cathedral Ceiling Spprt. Box 4 x 6-5/8" Blk.	4DT-CCS	1604424B
5 x 8	Cathedral Ceiling Spprt. Box 5 x 8" Blk.	5DT-CCS	1605424B

SIZE	DIM A	DIM B
4 x 6-5/8"	10.625"	14.0"
5 x 8"	10.625"	14.0"

RESTRICTION DISK

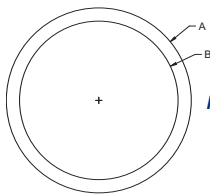

NOTE: Use in accordance with appliance manufacturer's instructions only.

Size	Description	Part #	Sk#
4 x 6⁵/₈	Restriction Disk 4 x 6-5/8"	4DT-RD	1604285

SIZE	DIM A	DIM B
4 x 6-5/8"	5.25"	4.50"

OFFSET SUPPORT

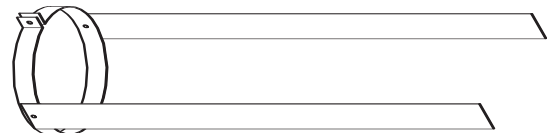

Size	Description	Part #	Sk#
4 x 6⁵/₈	Offset Support 4 x 6-5/8"	4DT-OS	1604435
5 x 8	Offset Support 5 x 8"	5DT-OS	1605435

VINYL SIDING STANDOFF

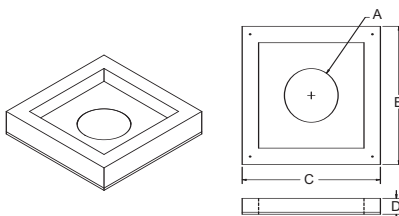

Size	Description	Part #	Sk#
4 x 6⁵/₈	Vinyl Siding Standoff 4 x 6-5/8"	4DT-VS	1604806
5 x 8	Vinyl Siding Standoff 5 x 8"	5DT-VS	1605806

SIZE	DIM A	DIM B	DIM C	DIM D
4 x 6-5/8"	6.7"	17.4"	17.4"	2.0"
5 x 8"	8.27"	19.86"	19.86"	2.0"

Parts & Accessories

FIRESTOP SPACER

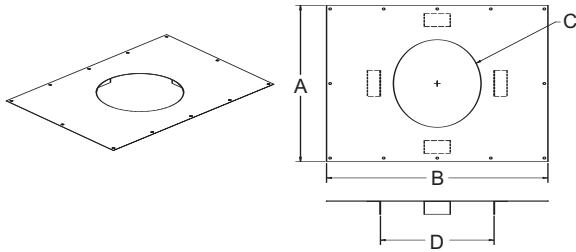

Size	Description	Part #	Sku #
4x6⁵/₈	Firestop Spacer 4 x 6-5/8"	4DT-FS	1604500
5x8	Firestop Spacer 5 x 8"	5DT-FS	1605500

SIZE	DIM A	DIM B	DIM C	DIM D
4 x 6-5/8"	12.0"	17.0"	6.72"	8.73"
5 x 8"	14.0"	17.0"	8.125"	10.125"

NOTE: Required when penetrating combustible materials. Refer to our installation instructions for specific requirements.

WALL THIMBLE

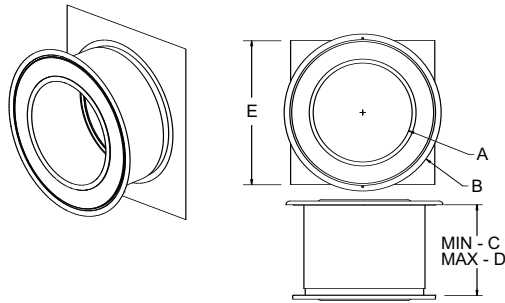

Size	Description	Part #	Sku #
4x6⁵/₈	Wall Thimble 4 x 6-5/8" Black	4DT-WT	1604460B
5x8	Wall Thimble 5 x 8" Black	5DT-WT	1605460B

SIZE	DIM A	DIM B	MIN C	MAX D	MAX E
4 x 6-5/8"	6.75"	14.0"	3.70"	7.00"	13.00"
5 x 8"	8.125"	19.0"	6.0"	11.0"	—

NOTE: Two-piece wall thimble easily slides together for installation on wall thicknesses of 4" to 7". Serves a dual purpose as both a heat shield and firestop.

TRIM PLATE

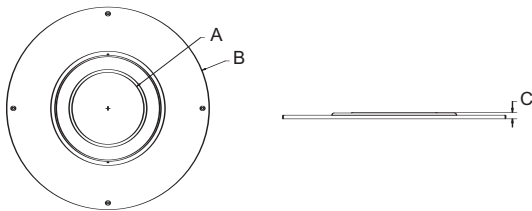

Size	Description	Part #	Sku #
4x6⁵/₈	Trim Plate 4 x 6-5/8" Black	4DT-TP	1604502
5x8	Trim Plate 5 x 8" Black	5DT-TP	1605502

SIZE	DIM A	DIM B	DIM C
4 x 6-5/8"	6.75"	19.0"	.50"
5 x 8"	8.125"	19.0"	.312"

NOTE: Used to provide a finished look at the ceiling for vertical installations.

CEILING SUPPORT

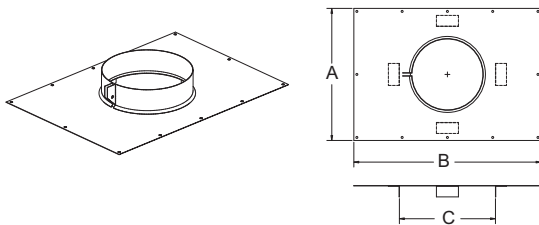

Size	Description	Part #	Sku #
4x6⁵/₈	Ceiling Support 4 x 6-5/8"	4DT-CS	1604400
5x8	Ceiling Support 5 x 8"	5DT-CS	1605400

SIZE	DIM A	DIM B	DIM C
4 x 6-5/8"	12.0"	17.0"	8.73"
5 x 8"	14.0"	17.0"	10.125"

NOTE: Required when penetrating floors on multi-story applications.

WALL SUPPORT BAND

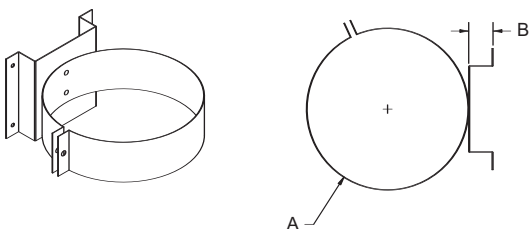

Size	Description	Part #	Sku #
4x6⁵/₈	Wall Support/Band 4 x 6-5/8"	4DTWS/B	1604430
5x8	Wall Support/Band 5 x 8"	5DTWS/B	1605430

SIZE	DIM A	DIM B
4 x 6-5/8"	6.625"	1.0"
5 x 8"	8.0"	1.0"

CO-LINEAR – PARTS AND ADAPTERS

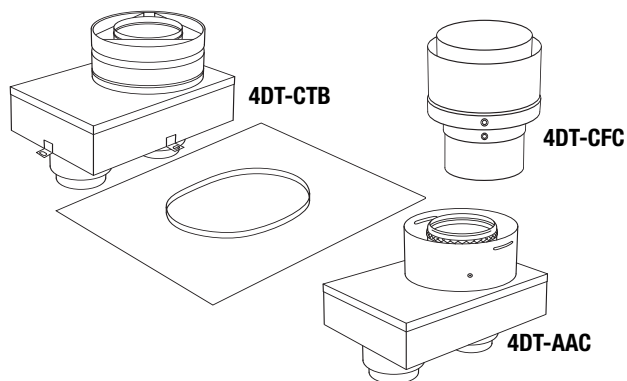

Size	Description	Part #	SKU #
4 x 6 5/8	Co-Linear Termination Box with Baseplate	4DT-CTB	1604650
	Co-Linear Appl. Adapter-Standard	4DT-AAC	1604655
	Co-Linear Appl. Adapter-Vermont Castings	4DT-AACV	1604656
	Co-Linear Appl. Adapter-Travis Industries	4DT-AACT	1604657
	Co-Linear Flex Connector	4DT-CFC	1604085

NOTE: Use with 3" Selkirk aluminum flexible chimney liner, Model AFCL (sold separately), or equivalent.

TERMINATION KITS

Horizontal Termination Kit "A" Includes:

90 Degree Elbow, Wall Thimble, Horizontal Termination & Appliance Adapter

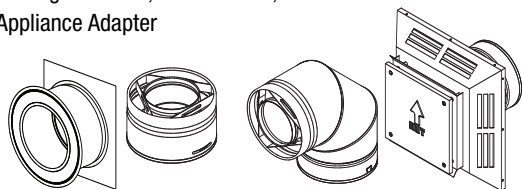

Vertical Termination Kit Includes:

Adjustable Flashing 0/12-6/12, Appliance Adapter, Storm Collar & Vertical Termination

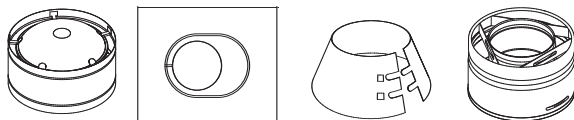

Horizontal Termination Kit "B" Includes:

90 Degree Elbow, Wall Thimble, Horizontal Termination, Appliance Adapter, 24" Pipe & Adjustable Length Pipe (4-10")

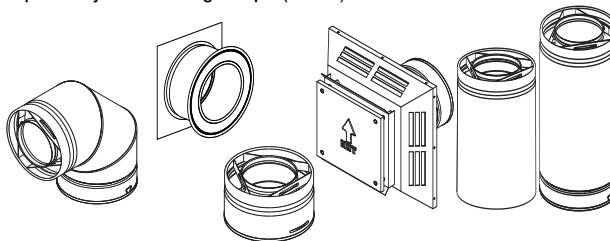

Size	Description	Part #	SKU #
4 x 6 5/8	Vertical Termination Kit	4DT-VKC	1604620
	Horizontal Termination Kit "A"	4DT-HKA	1604621
	Horizontal Termination Kit "B"	4DT-HKB	1604622

CHIMNEY CONVERSION KITS - USA Only

Size	Description	Part #	SKU #
4 x 6 5/8	Masonry Chimney Conversion Kit	4DT-MCK	1604630
	CHIM. CONV. KIT A (for 6" ID/8" OD Class A Chimney)	4DT-CCKA	1604631
	CHIM. CONV. KIT B (for 6" ID/10" OD Class A Chimney)	4DT-CCKB	1604635



Masonry Chimney Conversion Kit

Connect to a masonry chimney using Selkirk aluminum flexible chimney liner – Model AFCL (sold separately)



Chimney Conversion Kit

Connect to a 6" I.D. Class A chimney using Selkirk aluminum flexible chimney liner – Model AFCL (sold separately)

WORLD HEADQUARTERS

P.O. Box 831950
Richardson, Texas 75083-1950
(800) 992-8368 (VENT)
Toll Free Fax: (877) 393-4145
www.selkirkusa.com

SALES OFFICES & CUSTOMER SERVICE

UNITED STATES

P.O. Box 831950
Richardson, Texas 75083-1950
(800) 992-VENT (8368)
Toll Free Fax: (877) 393-4145

CANADA

375 Green Road
Stoney Creek, Ontario
Canada L8E 4A5
(905) 662-6600
Fax: (905) 662-5352
www.selkirkcanada.com

RESEARCH & DEVELOPMENT

VENTING R&D

St. Rt. 93 N. & Sutton Rd.
Logan, Ohio 43138
(740) 385-5666
Fax: (740) 385-2483

MANUFACTURING

UNITED STATES

1820 E. Fargo Ave.
Nampa, Idaho 83687-6824
(208) 467-7411
Fax: (208) 467-7412

7571 West Highway 153
P.O. Box 427
Winters, Texas 79567
(325) 754-4571
Fax: (325) 754-4764

CANADA

1400 California Ave.
P.O. Box 160, Brockville, Ontario
Canada K6V 5V3
(613) 342-6655
(800) 267-8178
Fax: (613) 342-2735

MEXICO

Justo Sierra Y 2 da Avenida
Ojinaga, Chihuahua, Mexico
011 52 (626) 453-2884/85
Fax: 011 52 (626) 453-2886

TECHNICAL SUPPORT

REGISTER, GRILLE & DIFFUSER

(800) 992-8368
Fax: (877) 393-4145
Email: Airmatesupport@selkirkinc.com

CHIMNEY & VENTING

US - (800) 848-2149 ext. 2212
Fax: (740) 385-2483
Email: Metalbestosupport@selkirkinc.com
CANADA - (888) SELKIRK (735-5475)
Fax: (866) 835-9624
Email: info@selkirkcanada.com

Two Components that will Revolutionize the Pellet Industry

Selkirk's New Direct Vent System for Pellet Appliances

Selkirk's revolutionary Direct-Temp® direct vent system for gas appliances is now also UL listed for pellet burning appliances. Our two new innovative components will allow you to convert any pellet appliance into a simpler, cleaner and more efficient direct vent system.

ADVANTAGES - DIRECT-TEMP® for Pellet

- Inherent design of Direct-Temp® eliminates fly ash into room
- 1" clearance to combustibles
- Preheats intake air for more efficient combustion
- Gasketed joints eliminate need for messy sealant
- One installation includes outside air for combustion
- Single stack looks more like a wood burning stove

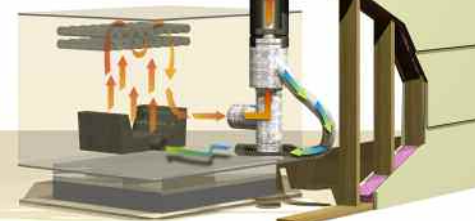

Patent Pending

Order Catalog # SDTPELLETB or call your Customer Service Representative for more information

CONDITIONS OF SALE

GUARANTEE

All Selkirk venting products are now backed with a Lifetime Limited Warranty. Please refer to the warranty included with the product for specific details or contact customer service for a copy.

PRICES & DISCOUNTS

See our price list and discount sheet for current pricing information. Orders will be invoiced at prices in effect at time order is placed. All prices subject to change without notice. All Selkirk L.L.C. products may be combined to achieve required discount levels.

CREDIT

Shipments will be made on open account to those firms with established credit ratings with us.

RESPONSIBILITY

Selkirk L.L.C. cannot assume responsibility for loss or damages to products in transit or for delays of carriers delivering our products. In case of loss, visible or concealed damage, you as a consignee must report such loss to carrier at once and file a claim.

FREIGHT

All shipments are F.O.B. our facilities.

RETURNED GOODS

No merchandise may be returned for credit without prior written permission, shipping instructions and return authorization number. All items authorized for return must be in new and resalable condition in unopened cartons and transportation charges must be prepaid. A 25% restocking charge will be made on all returns to cover the costs of handling and inspection. Up to a 15% refurbishment charge will be applied as needed.

BROKEN CARTONS

Any order requiring quantities of product less than a complete carton will be charged an additional fee. Please contact your local representative for pricing.

TRANSPORTATION

Method of transportation and shipping point will be decided by Selkirk L.L.C. If our customer requests special routing, the order will be shipped prepaid and charged.

Fax U.S. orders to
TOLL FREE
(877) 393-4145

Customer Service
(800) 992-8368 (VENT)

Fax Canadian orders to
TOLL FREE
(866) 835-9624

Customer Service
(888) SELKIRK (735-5475)

www.selkirkusa.com
(800) 992-8368 (VENT)

www.selkirkcanada.com
(888) SELKIRK (735-5475)



SELKIRK L.L.C. is a leading manufacturer of venting products for residential, commercial and industrial applications. Current operations include locations in the United States, Canada and Mexico. SELKIRK L.L.C. has been supplying the finest venting products for over 80 years.