

# Designer Wood Burning Fireplaces



624WBST See-Thru Wood Burning Fireplace shown with standard black bifold doors.

## 624WBST See-Thru Wood Burning Fireplace

### Features:

- Extra large glass viewing area with standard black bifold glass doors
- Standard radiant design provides the ability for a masonry look finish
- Fireplace interiors have all refractory brick to provide a realistic masonry look, with steel mesh molded in for durability
- Uses "L" series chimney system, making installation simple
- Removeable heavy duty grate allows for easy clean up of ashes
- Sturdy nailing flange secures unit during construction
- Gas appliance knockouts for adding gas appliances
- Black fire screens to protect against sparks
- 25-year warranty ensures dependability

- OMNI-Test Laboratories, Inc. design certified

### Optional Accessory:

- Outside Combustion Air Kit (AK4)

*Heat with  
Personality.*

**MONESSEN**  
HEARTH SYSTEMS





624WBPF Peninsula Wood Burning Fireplace shown with optional polished brass bifold doors.

## 624WBPF Peninsula Wood Burning Fireplace

### Features:

- Large viewing area offers unrestricted enjoyment of the fire
- Standard clean face design provides the ability for a masonry look finish
- Fireplace interiors have all refractory brick to provide a realistic masonry look, with steel mesh molded in for durability
- Uses "L" series chimney system, making installation simple
- Removable heavy duty grate allows for easy clean up of ashes
- Sturdy nailing flange secures unit during construction

- Gas appliance knockouts for adding gas appliances
- Black fire screens to protect against sparks
- 25-year warranty ensures dependability
- OMNI-Test Laboratories, Inc. design certified

### Optional Accessory:

- Polished brass glass doors (WH22) (1 required), (WH36) (2 required)
- Outside Combustion Air Kit (AK4)





624WBCR Corner Wood Burning Fireplace shown with optional polished brass bifold doors.

## 624WBCR/624WBCL Corner Wood Burning Fireplaces

### Features:

- Baked on enamel paint for years of use
- Fireplace interiors have all refractory brick to provide a realistic masonry look, with steel mesh molded in for durability
- Tilted grate allows for easy ash removal
- Sturdy full-length nailing flange secures unit during construction
- Gas appliance knockouts for adding gas appliances
- Built in flue damper to reduce heat loss when fireplace is not in use
- Flush front design to create the look of a true masonry fireplace

- Black fire screens to protect against sparks
- 25-year warranty ensures dependability
- U.L. listed for safety

### Optional Accessory:

- Wide view glass doors:  
Polished brass finish (WB36LR) (required)
- Outside Combustion Air Kit (OAC4)

# SPECIFICATIONS

Product Specifications									
Model	Width		Height		Depth		Opening Dimensions (W x H x D)	Radiant or Circulating	Design Certified
	Actual	Framing	Actual	Framing	Actual	Framing			
624WBSTB	42"	43-1/2"	47"	47-1/4"	25-1/2"	24-1/2"	38" x 23-1/4" x 25-1/2"	Radiant	OMNI
624WBPF	38"	38"	46"	46-1/4"	24"	23"	36" x 23-1/4" x 22"	Radiant	OMNI
624WBCL/CR	38"	38"	45"	45-1/4"	23"	23-1/2"	36" x 22-11/16" x 22-1/2"	Radiant	UL

## Corner (624WBCL/CR) Fireplaces ("S" Series Double Wall Chimney)

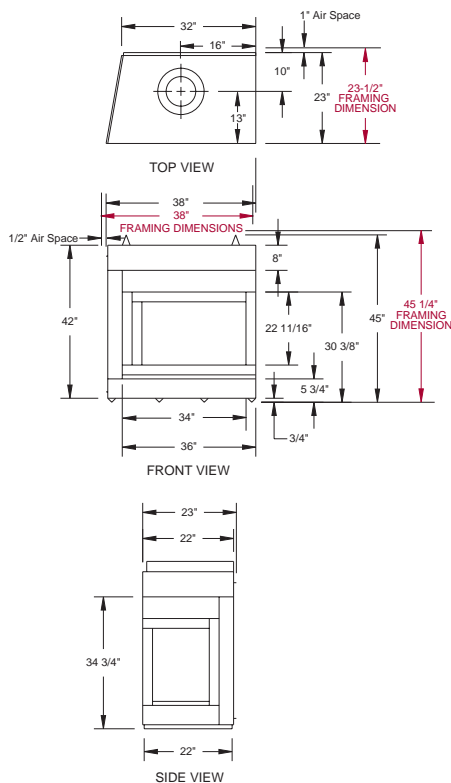

## Peninsula (624WBPF) Fireplace ("L" Series Double Wall Chimney)

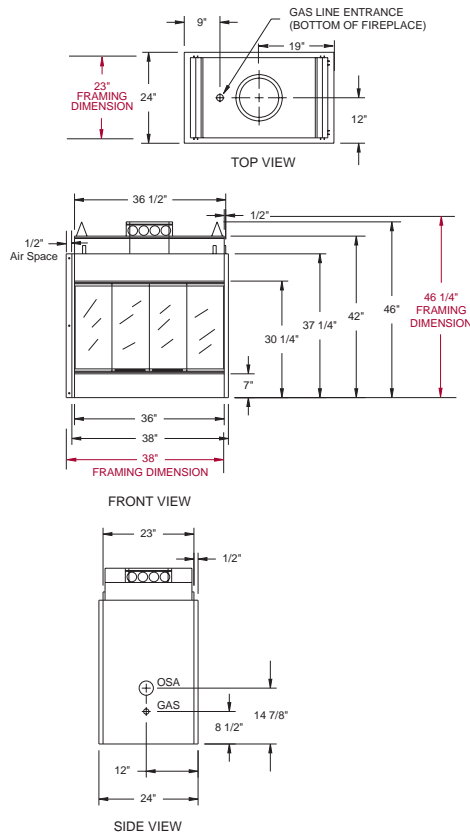

## Super See-Thru (SST) Fireplace ("L" Series Double Wall Chimney)

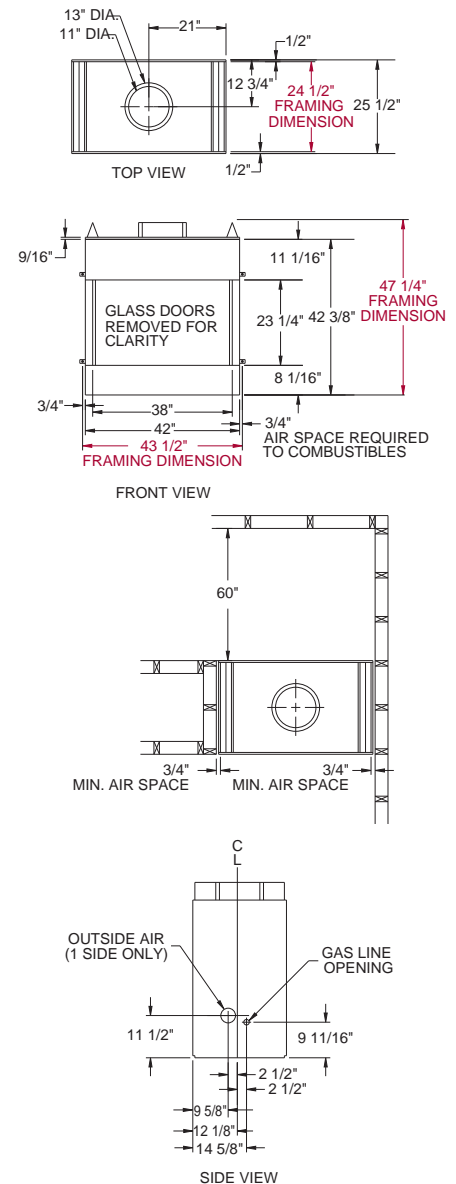

**MONESSEN**  
HEARTH SYSTEMS

149 Cleveland Drive • Paris, Kentucky 40361

[www.monessenhearth.com](http://www.monessenhearth.com)

To avoid personal injury or property damage, the product described by this brochure must be installed, operated and maintained in strict compliance with the instructions packaged with the product and all applicable building or fire codes. Contact local building or fire officials about restrictions and installation inspection requirements. All photographs and drawings on this brochure are for illustrative purposes only and are not intended for, nor should they be used as a substitute for the instructions packaged with the unit. Appearance and specifications of the product are subject to change without notice.

© 2004 Monessen Hearth Systems, Inc.



MADE IN U.S.A.

WBDesigner-MHS6104

Sold by:

Rev. 10-04