

Add warmth and charm to your home with
natural radiant heat

 EPA APPROVED
MODEL HE40
WOOD FIREPLACE



The HE40-EPA High-Efficiency Wood Burning Fireplace provides warmth and comfort - Uniquely styled and built-in

Wood Fireplace Technology

Feel the warm embrace of a clean burning wood fire. A clean burn is achieved with non-catalytic wood burning technology. Low emissions are achieved through High Tech design to reduce maintenance and cost.

HE40-EPA Specifications*

- Heats up to 2,000 sq. ft. with a heat output of up to 45,500 BTUs and 8 to 10 hour Burn time (may vary depending on heat loss characteristics of each home and quality of wood burned).
- Large 2.0 cubic ft. firebox holds 22" logs.
- EPA approved at 5.7 g/hr.
- Listed with 6" or 7" diameter Insulated Chimney models CF & UT.
- Installs with Zero Clearance to combustibles.
- Limited Lifetime Warranty.
- Weight: 405 lbs - 184 kgs.
- Safety tested and listed to Standards in Canada and the United States: ULC S610 and UL 127 for zero clearance factory built fireplaces.

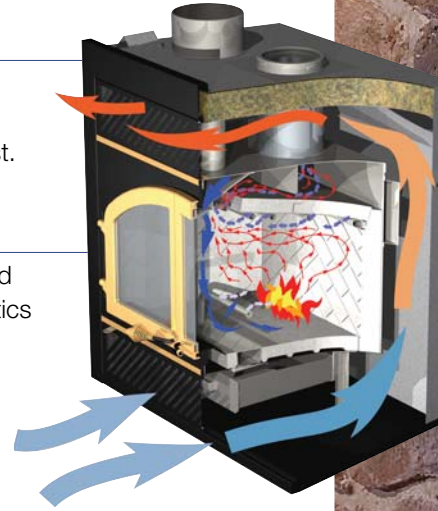

Model HE40-EPA is a well-built permanent part of your home. With minimal maintenance, it will last for generations providing years of enjoyment and maximum return on your investment.

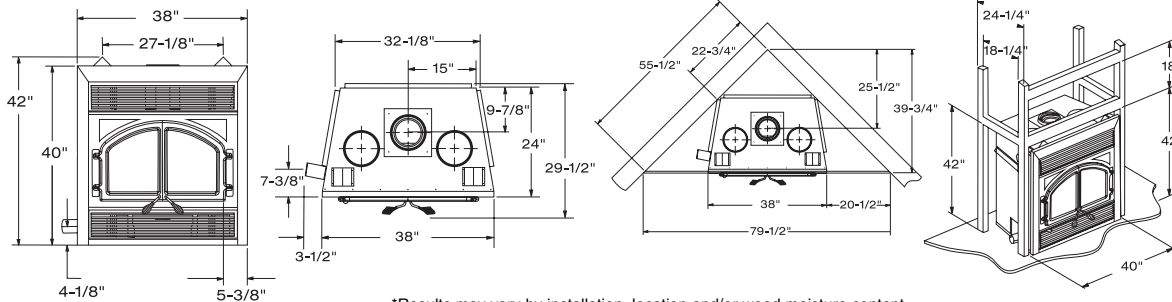

*Results may vary by installation, location and/or wood moisture content.

24K Gold Double Door Design



24K Gold Single Door Design



Nickel Single Door Design



Black Single Door Design

HE40-EPA has many impressive design features



- EPA Approved (Environmental Protection Agency).
- Front Glass stays clean to view the roaring fire with our unique Contoured Air Wash System.
 - Stainless Steel Log Retainer doubles as a pilot to energize low burn cycle.
 - The Outside Air Kit acts as a primary air supply.
 - Attractive "Herringbone" Refractory Brick Liner retains heat.
 - Five Stainless Steel Secondary Air Tubes provide an "afterburner" for secondary combustion and a clean burn without a catalytic combustion system.
- The HE40-EPA is certified as a furnace.
(CSA B366.1)



Nickel Double Door Design



Black Double Door Design

Central Heating

The HE40-EPA can be used as a furnace to centrally heat your home. The ducting must be independent from all other appliances. Refer to installation instructions for additional details.

Zone Heating

Ducting can be installed for up to three separate zones in your home and each zone can be controlled individually using our zone heating control and zone dampers.

Ducting Options

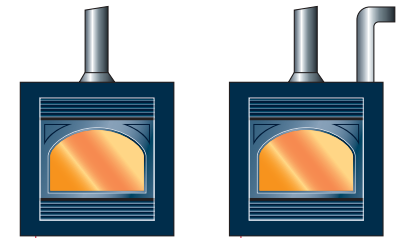

No Ducting

Gravity Vent Kit

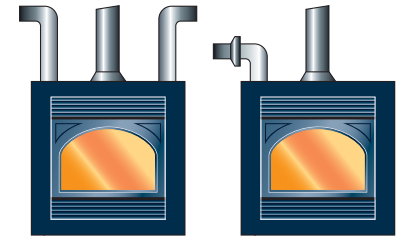

2 Gravity Vent Kits

Central Heating Duct Kit

In the interest of constant product improvement, we reserve the right to change specifications without notice. Before installation, please read installation instructions and check all local Building Codes.

Why heat with wood?

Because you appreciate the warmth and beauty of a fire, you chose a wood-burning fireplace. Not only is it attractive and functional, it's also an environmentally responsible choice. Wood energy is a renewable resource—like solar and wind power, it can be used forever without depleting the earth. Burning wood in your home completes nature's carbon cycle: a tree absorbs carbon dioxide from the air to grow, stores it, then releases it as it decays or is burned for fuel.

It's good to know wood fires do not contribute to global warming. No extra carbon dioxide is being released in your fireplace than the tree would release if left untouched. Fossil fuels release old carbon that was stored deep in the earth, creating the excess warmth and weather variances that are causing so much concern. Instead, you've chosen to use wood for heat, a choice that lessens the impact on our fragile environment.

Functional Features that add to your enjoyment

- 1 Optional Internal Fan System to increase warm air circulation
- 2 Attractive framed Black Louvers allow generous air flow into your room
- 3 Solid Cast Face Plate and Doors resist warping and maintain a tight seal in-order to maintain high-efficiency
- 4 Extra Large Viewing Area, up to 22" x 14" (Single Doors)
- 5 Black, 24K Gold or Nickel Door Finishes



- 6 Heat Radiating High Temperature Ceramic Glass
- 7 Stainless Steel Log Retainer
- 8 Single or Double Door Designs with easy to operate handles
- 9 EZ Adjust Combustion Air Control allows for regulation of burn rate
- 10 Large capacity integrated Ash Pan Drawer with carrying handle



In the interest of constant product improvement, we reserve the right to change specifications without notice. Before installation, please read installation instructions and check all local Building Codes.



375 Green Road
Stoney Creek, ON L8E 4A5
Phone: (905) 662-6600 • Fax: (905) 662-5352
Toll Free: 1-888-SELKIRK (735-5475) • Fax: 1-866-835-9624



Visit www.selkirkcanada.com