

**IMPORTANT:
THESE INSTRUCTIONS ARE TO
REMAIN WITH THE
HOMEOWNER**

WARNING: If the information in these instructions is not followed exactly, a fire or explosion may result causing property damage, personal injury or loss of life.

--Do not store or use gasoline or other flammable vapours and liquids in the vicinity of this or any other appliance.

--WHAT TO DO IF YOU SMELL GAS

- Do not try to light any appliance.
- Do not touch any electrical switch; do not use any phone in your building.
- Immediately call your gas supplier from a neighbour's phone. Follow the gas supplier's instructions.
- If you cannot reach your gas supplier, call the fire department.

--Installation and service must be performed by a qualified installer, service agency or the gas supplier.

This appliance may be installed in an aftermarket permanently located, manufactured (mobile) home, where not prohibited by local codes.

This appliance is only for use with the type of gas indicated on the rating plate. This appliance is not convertible for use with other gases, unless a certified kit is used.



**PACIFIC
ENERGY**

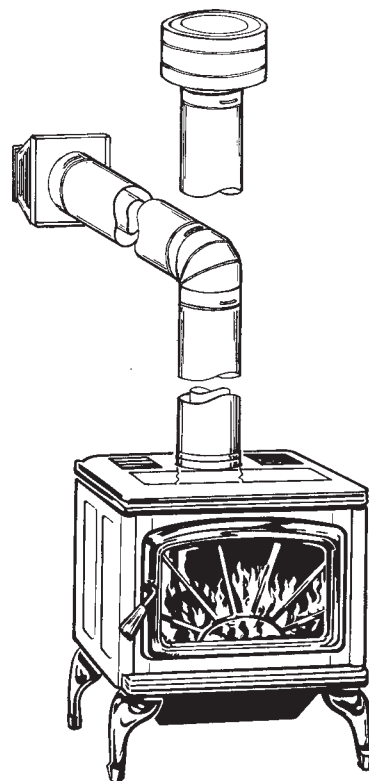

***Classic Gas
and
Super 27 Gas***

**SERIES A
DIRECT VENT HEATER**

**INSTALLATION
AND OPERATING
INSTRUCTIONS**

Contents

| | |
|---|----|
| CAUTION | 3 |
| SAFETY | 4 |
| MAINTENANCE | 4 |
| BASE KIT INSTALLATION | 5 |
| DOOR KIT INSTALLATION | 5 |
| GAS SUPPLY | 6 |
| FLOOR PROTECTION | 6 |
| ATTACHMENT TO FLOOR | 6 |
| CLEARANCES | 6 |
| VENTING REQUIREMENTS | 7 |
| WALL TERMINATION VENTING | 8 |
| ROOF TERMINATION VENTING | 9 |
| VENT RESTRICTOR ADJUSTMENT | 10 |
| VENT TERMINAL CLEARANCES | 11 |
| GLOWING EMBERS | 12 |
| INPUT RATE CONVERSION | 13 |
| PROPANE CONVERSION | 14 |
| LOG SET | 15 |
| LIGHTING INSTRUCTIONS | 16 |
| FIRST FIRE | 16 |
| OPERATION | 17 |
| PRIMARY AIR ADJUSTMENT | 17 |
| OPTIONAL WALL SWITCH OR THERMOSTAT | 18 |
| OPTIONAL BLOWER | 19 |
| REPLACEMENT PARTS - Classic Gas | 20 |
| REPLACEMENT PARTS - Super 27 Gas | 21 |
| REPLACEMENT PARTS - Burner Assembly | 22 |
| RATING LABEL | 23 |

Important: When lit for the first time, the appliance will emit a slight odour for a couple of hours. This is due to the curing of paints, sealants and lubricants used in the manufacturing process. This condition is temporary. Open doors and windows to ventilate area. If optional fan kit has been installed, place fan in the "OFF" position. Smoke and fumes caused by the curing process may cause discomfort to some individuals.

It is normal for fireplaces fabricated of steel to give off some expansion and/or contraction noises during the start up or cool down cycle. Similar noises are found with your furnace heat exchanger or cook stove oven.

CAUTION

FOR YOUR SAFETY - Do not install or operate your Pacific Energy heater without first reading and understanding this manual. Any installation or operational deviation from the following instructions voids the Pacific Energy Warranty and may prove hazardous.

This appliance and its individual shutoff valve must be disconnected from gas supply piping system during any pressure testing of that system at test pressures in excess of 1/2 psig. (3.5 kPa).

This appliance must be isolated from the gas supply piping system by closing its individual manual shutoff valve during any pressure testing of the gas supply piping system at test pressures equal to or less than 1/2 psig. (3.5 kPa).

Fig # 1

Classic Gas

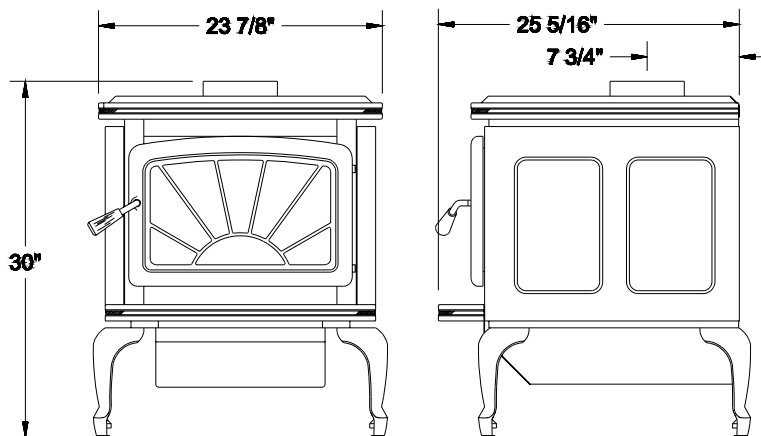

Super 27 Gas

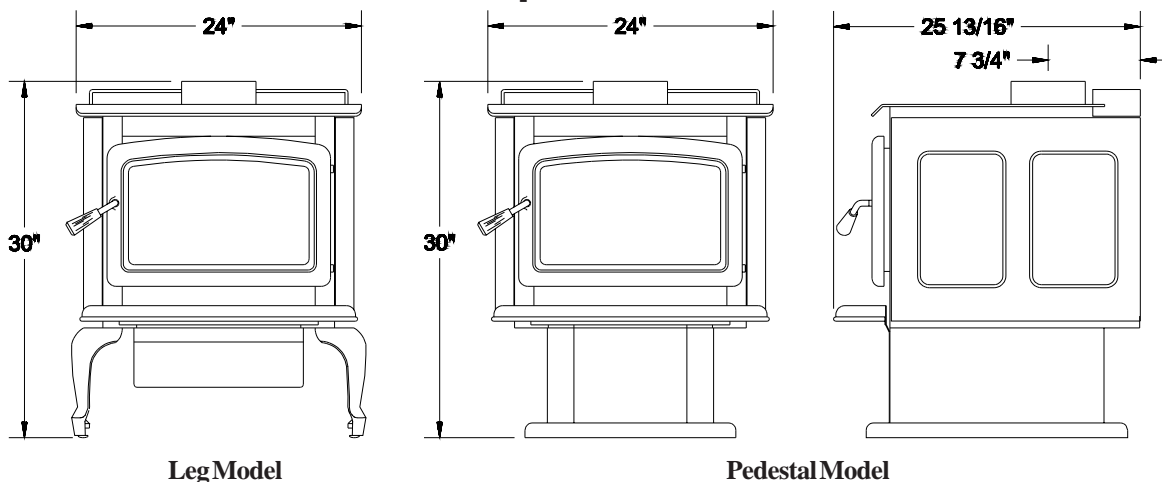

SAFETY

- Due to high temperatures, this gas appliance should be located out of traffic and away from furniture and draperies.
- Children and adults should be alerted to the hazards of high surface temperatures and should stay away to avoid burns or clothing ignition.
- Young children should be carefully supervised when they are in the same room as the appliance.
- Clothing or other flammable material should not be placed on or near the appliance.
- Under no circumstances should this fireplace be modified. Any grill, panel or door removed for servicing the unit must be replaced prior to operating. Failure to do so may create a hazardous condition.
- Installation and repair should be done by a qualified service person. The appliance should be inspected before use and at least annually by a professional service person. More frequent cleaning may be required due to excessive lint from carpeting, bedding material, etc. It is imperative that control compartments, burners and circulating air passageways of the appliance be kept clean.

It is Pacific Energy's policy that no responsibility is assumed by the Company or by any of its employees or representatives for any damages caused by an inoperable, inadequate, or unsafe condition which is the result, either directly or indirectly, of any improper operation or installation procedures.

MAINTENANCE

Caution: Turn off gas and electrical power supply and allow ample time for unit to cool before servicing appliance. It is recommended that this appliance and venting should be inspected at least once a year by a qualified service person. Do not use this heater if any part has been under water. Immediately call a qualified service technician to inspect the heater and to replace any part of the control system or gas control which has been under water.

Door Glass

Warning: Do not operate appliance with glass panel removed, cracked or broken. Replacement of glass should be done by a licensed or qualified service person.

Do not strike or otherwise impact the glass in anyway that may cause it to break. If the glass becomes cracked or broken, it must be replaced before using the fireplace. Replacement glass can be obtained from your nearest Pacific Energy dealer. The size required is 9 1/8" x 15 5/8" x 5 mm. Use ceramic glass only. **Do not substitute with any other type.** To remove broken glass, undo the four retaining screws and remove the frame, noting position for re-assembly. Remove all particles of glass. Be careful as they are very sharp. Install new glass complete with gasket. Replace frame and screws.

Annual Inspection:

- a) Clean air passage ways of excessive lint and dust buildup from carpeting, bedding material, etc. The flow of ventilation air must not be obstructed.
- b) Inspect logs and burner assembly for lint and soot build-up. If excessive build-up of soot is present, have a qualified service person inspect and adjust unit for proper combustion. Clean logs and burner with a vacuum cleaner, paying close attention to the ports on the burner.
- c) Check the pilot system for proper flame size and operation. Clean pilot free of lint and dust. (See Fig. #2)
- d) Check that the vent pipe and vent terminal are open and free from blockage or debris. If the venting system is disassembled for cleaning, it must be properly assembled and re-sealed.
- e) Check door and glass panel gasket, replace if necessary. It is important that the glass and door seal be maintained in good condition.

Note: The appliance area must be kept clear and free from combustible materials, gasoline and other flammable vapours and liquids.

Periodically:

- a) Viewing glass may be cleaned with fireplace glass cleaner.
- b) Exterior finish may be cleaned with mild soap and water.

Caution:

- do not use abrasive cleaners on glass or any other part of this appliance.
- do not clean glass when hot.

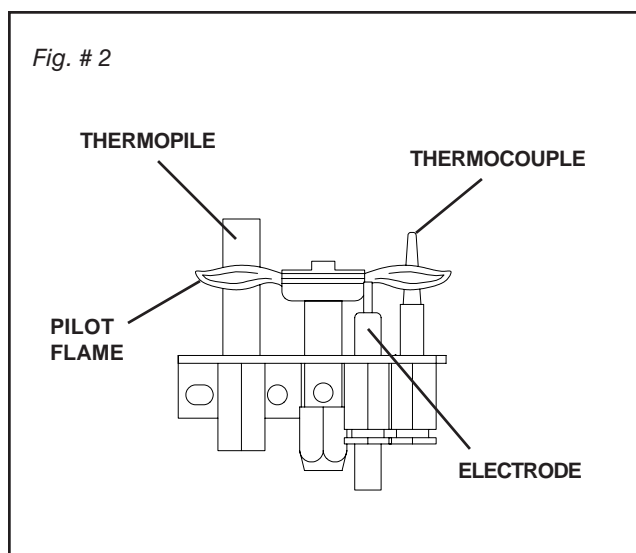

BASE KIT INSTALLATION

Crate removal

- 1) Carefully remove crate top, side supports and plastic cover bag.
- 2) Leave the unit on the pallet.

Leg Kit (Classic Gas model only)

- 1) Remove the 1/2" nuts and washers from the studs on the bottom corners of the stove using a 3/4" wrench. Save nuts and washers for later use.
- 2) Remove the lag bolts that secure the unit hold down brackets to the pallet.
- 2) Remove the hold down brackets and discard.
- 3) Position the legs onto the studs.
- 4) Place 1/2" washer over the studs and secure in place with 1/2" nut previously removed.
- 4) Remove the unit from the pallet and install.

Pedestal Kit (Super 27 Gas model only)

- 1) Remove the ash lip assembly and pedestal from the shipping box.
- 2) Align ash lip assembly mounting screws into slots of the pedestal door and secure in place.
- 3) Using a 3/4" wrench, remove the 1/2" nuts and washers from the studs on the bottom corners of the stove. Save nuts and washers for later use.
- 4) Lift the unit off the hold down brackets and carefully place unit on its back, taking care to not damage the restrictor positioning panel located on the back of the unit.
- 5) Align the pedestal mounting holes with the studs on the stove.
- 6) Secure the pedestal to the stove with the 1/2" nuts and washers previously removed.
- 7) Carefully place the unit in an upright position.

Leg Adapter (Super 27 Gas model only)

- 1) Remove the ash lip and adapter from the shipping box.
- 2) Align the ash lip mounting slots with the studs on the front control access door. Secure in place with 1/4" nuts.
- 3) Using a 3/4" wrench, remove the 1/2" nuts and washers from the studs on the bottom corners of the stove. Save nuts and washers for later use.
- 4) Lift the unit off the hold down brackets and carefully place unit on its back, taking care to not damage the restrictor positioning panel located on the back of the unit.
- 5) With the control access door facing up, align the adapter mounting holes with the studs on the stove bottom.
- 6) Position the legs on to the studs.
- 7) Place 1/2" washer over the studs and secure legs in place with 1/2" nut previously removed.
- 8) Carefully place the unit in an upright position.

DOOR KIT INSTALLATION

- 1) Remove door from packing box and inspect.
- 2) Position door onto hinge pins located on the right side of the firebox opening.
- 3) Latch door closed by lifting safety catch and rotating door handle counter-clockwise till latched.

Fig. #3



GAS SUPPLY

Caution: The gas line should be installed by a qualified service person in accordance with all building codes. Consult local and/or national building codes before proceeding.

Correct gas line diameter must be used to assure proper operation. The gas control is equipped with a captured screw type pressure test point, therefore it is not necessary to provide a 1/8 inch N.P.T. plugged tapping pressure test port for checking gas pressure immediately upstream of the gas supply connection to the appliance.

The gas valve inlet accepts a 3/8" N.P.T. fitting. For leg model units, it is recommended to use the optional flex gas connector (#GASC.GASCON). Route the gas connector inside the adapter to the rear. Fasten connector to the right side near the back with the bracket. Alternately, the gas supply line may enter through the 4" diameter hole located in the base of the leg adapter. This will allow the installation of the optional blower kit.

Correct gas pressure requirements:

| | Natural Gas | Propane |
|--|-------------|----------|
| Min. Pressure (For purpose of input adjustment) | 5.0" wc | 11.5" wc |
| Max. Pressure | 10.5" wc | 13.0" wc |
| Manifold Pressure | | |
| Maximum | 3.8" wc | 11.0" wc |
| Minimum | 1.1" wc | 2.9" wc |

FLOOR PROTECTION

Both, the Classic Gas and Super 27 Gas Heaters, may be installed directly on a combustible floor. If the appliance is to be installed directly on carpeting, combustible floor tile or other combustible material other than wood flooring, the appliance shall be installed on a metal or wood panel extending the full width and depth of the unit.

ATTACHMENT TO FLOOR

Mobile Home installations require that the appliance be firmly attached to the structure. Once the appliance is in it's final location, secure the unit in place through holes in the pedestal base. The holes are located on the left and right hand side of the base.

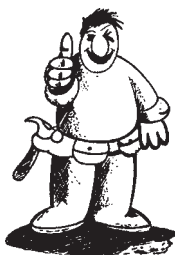

CLEARANCES

The minimum clearances from the appliance to combustibles are shown on Fig. #4. Adequate clearances around air openings and combustion air supplies are required.

Fig. #4

Minimum Clearance to Combustibles

| | | |
|------------------------------|--------|----------|
| Sidewall to Appliance | 3 in. | (76 mm) |
| Rearwall to Appliance | 2 in. | (51 mm) |
| Corner to Appliance | 2 in. | (51 mm) |
| Alcove sidewall to Appliance | 5 in. | (127 mm) |
| Alcove minimum width | 34 in. | (864 mm) |
| Alcove maximum depth | 48 in. | (1.2 m) |
| Alcove minimum height | 61 in. | (1.5 m) |

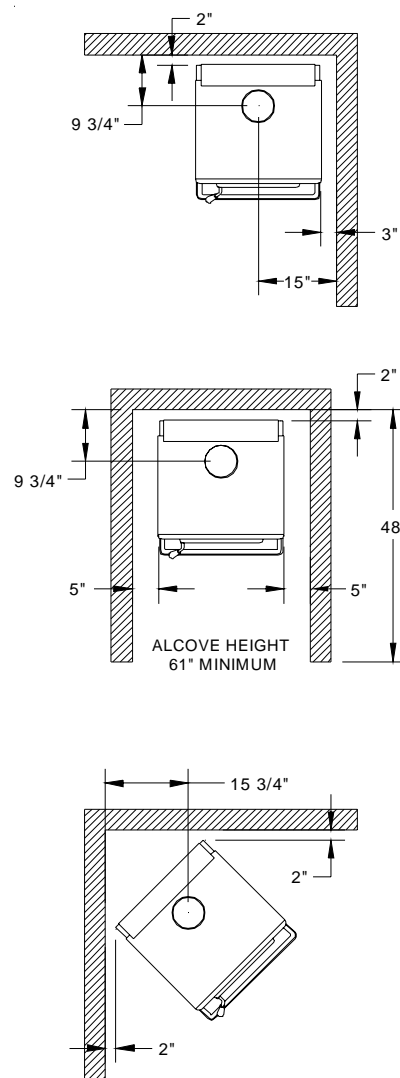

VENTING REQUIREMENTS

The heater installation and venting must conform with local codes or, in the absence of local codes, with the current Canadian Installation Code, CAN/CGA-B149.1 (in Canada) or the current National Fuel Gas Code, ANSI Z223.1 (in the USA). Only qualified (licensed or trained) personnel should install this product.

The Classic Gas and Super 27 Gas Heaters are tested and certified for use with SIMPSON DURA-VENT DIRECT VENT GS pipe or SECURITY CHIMNEYS SECURE VENT system. Vent components approved for use are listed in Figure 4. Kits for venting either through the wall or vertically through the roof are available from the vent system manufacturer or your nearest Pacific Energy Authorized Dealer.

Before installing the vent system, the installer should read these instructions to ensure proper installation requirements are maintained. Follow vent pipe manufacturer's instructions for assembly and installation.

Fig # 5

WALL TERMINATION **Minimum Installation**

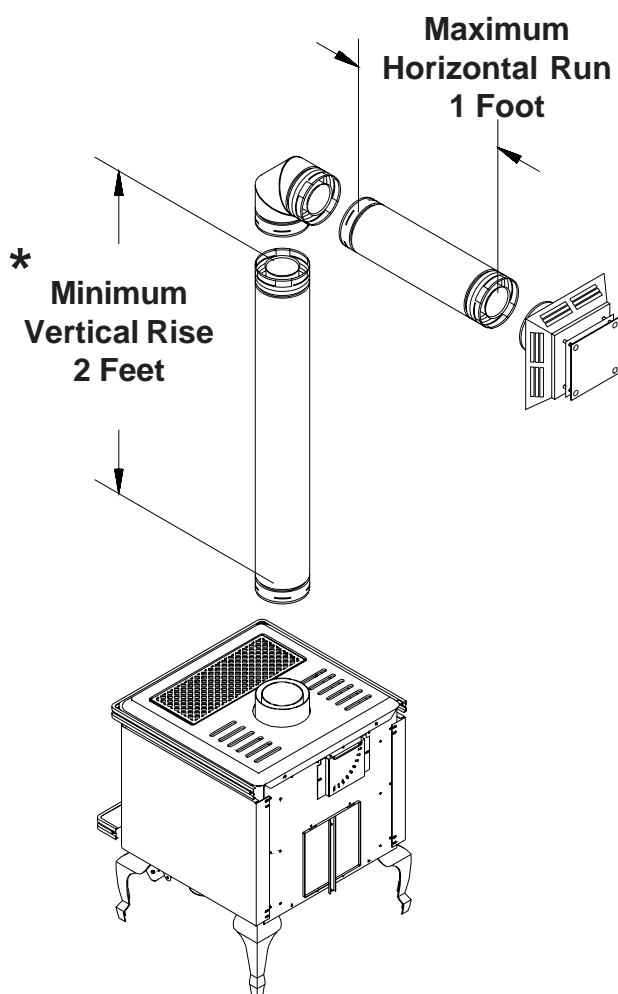

NO OTHER VENTING SYSTEMS OR COMPONENTS MAY BE USED.

CAUTION: UNDER NO CONDITION SHOULD COMBUSTIBLE MATERIAL BE CLOSER THAN 1 INCHES FROM ANY VERTICAL OR HORIZONTAL VENT SECTIONS.

Connections between each vent system component must be tightly joined and sealed, and secured with sheet metal screws at each joint.

Consult your local Building Codes before beginning the installation.

Vent Pipe Sealant

SIMPSON DURA-VENT DIRECT VENT GS pipe: All vent pipe sections must be sealed. Run a 1/8 inch wide bead of sealant around the male end of the outer pipe and female end of the inner pipe as shown below, and twist-lock the vent pipe sections together.

SECURITY CHIMNEYS SECURE VENT system: If only one elbow is used in the vent system, sealant is not required. Simply twist-lock the vent pipe sections together. If more than one elbow is used, apply sealant to inner sleeve of all elbows. Run a 1/8 inch wide bead of sealant around the female end of the inner pipe of elbow as shown below, and twist-lock the vent pipe sections together.

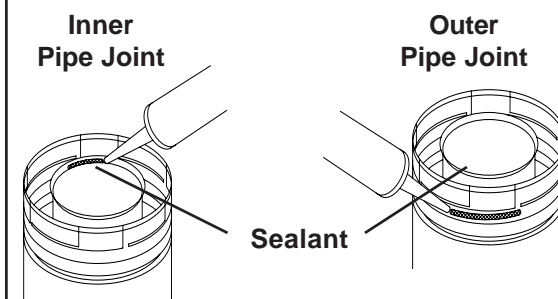

| Minimum Vertical Rise | Maximum Horizontal Run |
|------------------------------|-------------------------------|
| 2 Feet | 1 Foot |
| 3 Feet | 2 Feet |
| 4 Feet | 3 to 10 Feet |

* A minimum vertical rise of 2 feet is required for any wall termination. For horizontal runs greater than 1 foot, increase vertical rise equally. At 4 feet of vertical rise, horizontal run may be up to 10 feet.

Fig. # 6

WALL TERMINATION VENTING

A minimum vertical rise of 2 feet is required for any wall termination (see Fig. #5).

For horizontal runs greater than 1 foot, increase vertical rise equally. At 4 feet of rise, the horizontal run may increase up to and must not exceed 10 feet. A maximum of two 90° or 45° elbows may be used. If more than 2 elbows are used, reduce horizontal run by 2 feet for each additional set of elbows.

For optimum performance and flame appearance, keep the vent length to a minimum. Connections between each vent component must be tightly joined and sealed. A horizontal run of vent must have a 1/4 inch rise for every 1 foot of run towards the termination.

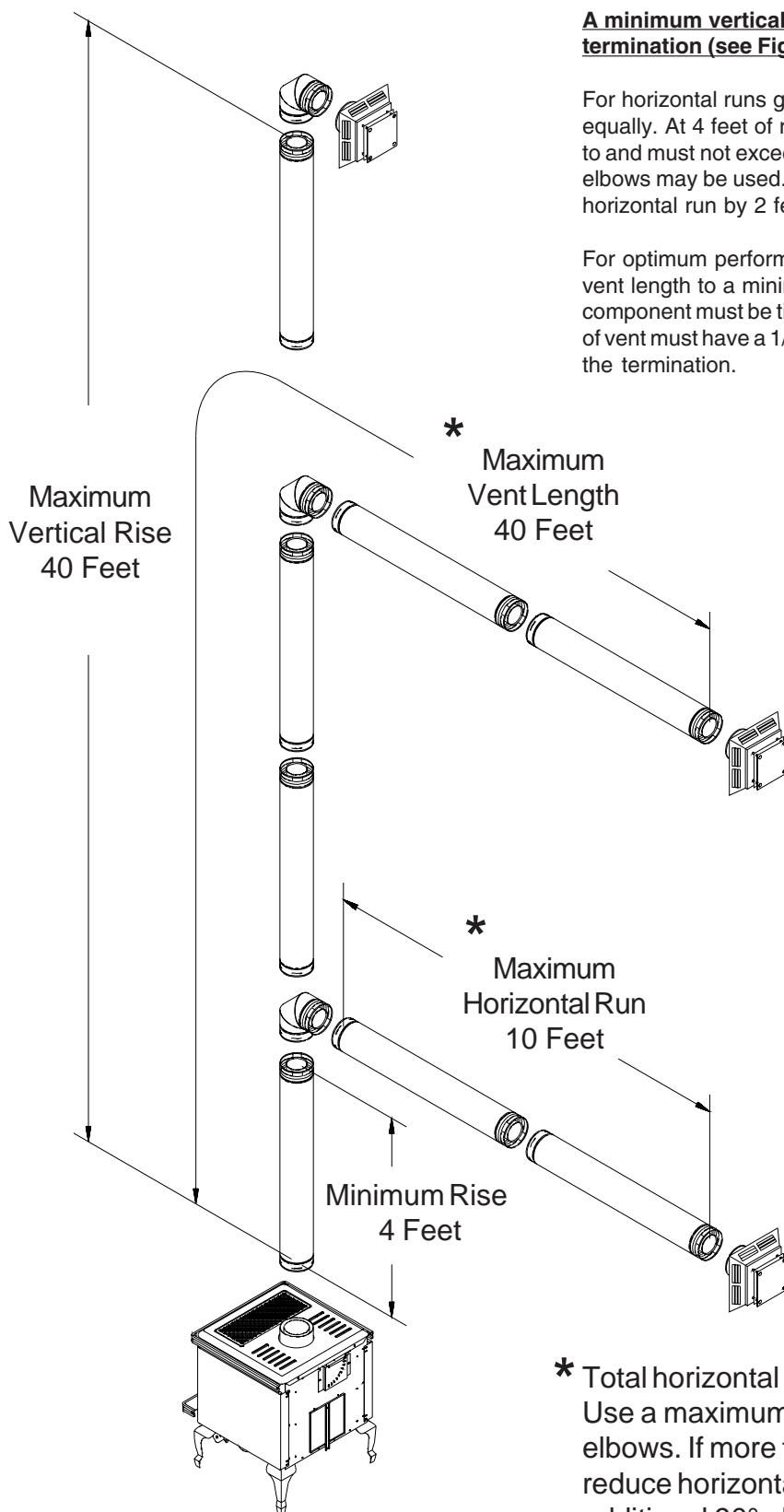

* Total horizontal run must not exceed 10 feet. Use a maximum of one 90° elbow or two 45° elbows. If more than 1 elbow is required, reduce horizontal run by 2 feet for each additional 90° elbow and 1 foot for each additional 45° elbow.

Fig. # 7

ROOF TERMINATION VENTING

A vertical rise of up to 40 feet is permitted with no horizontal offset. If an offset is required, ensure that the vertical rise is 1 foot greater than the horizontal offset. Horizontal offset must not exceed 10 feet. Combined vent length must not exceed 40 feet. If more than 2 elbows are used, reduce horizontal run by 2 feet for each additional elbow.

For optimum performance and flame appearance, keep the vent length to a minimum. Connections between each vent component must be tightly joined and sealed. A horizontal run of vent must have a 1/4 inch rise for every 1 foot of run towards the termination.

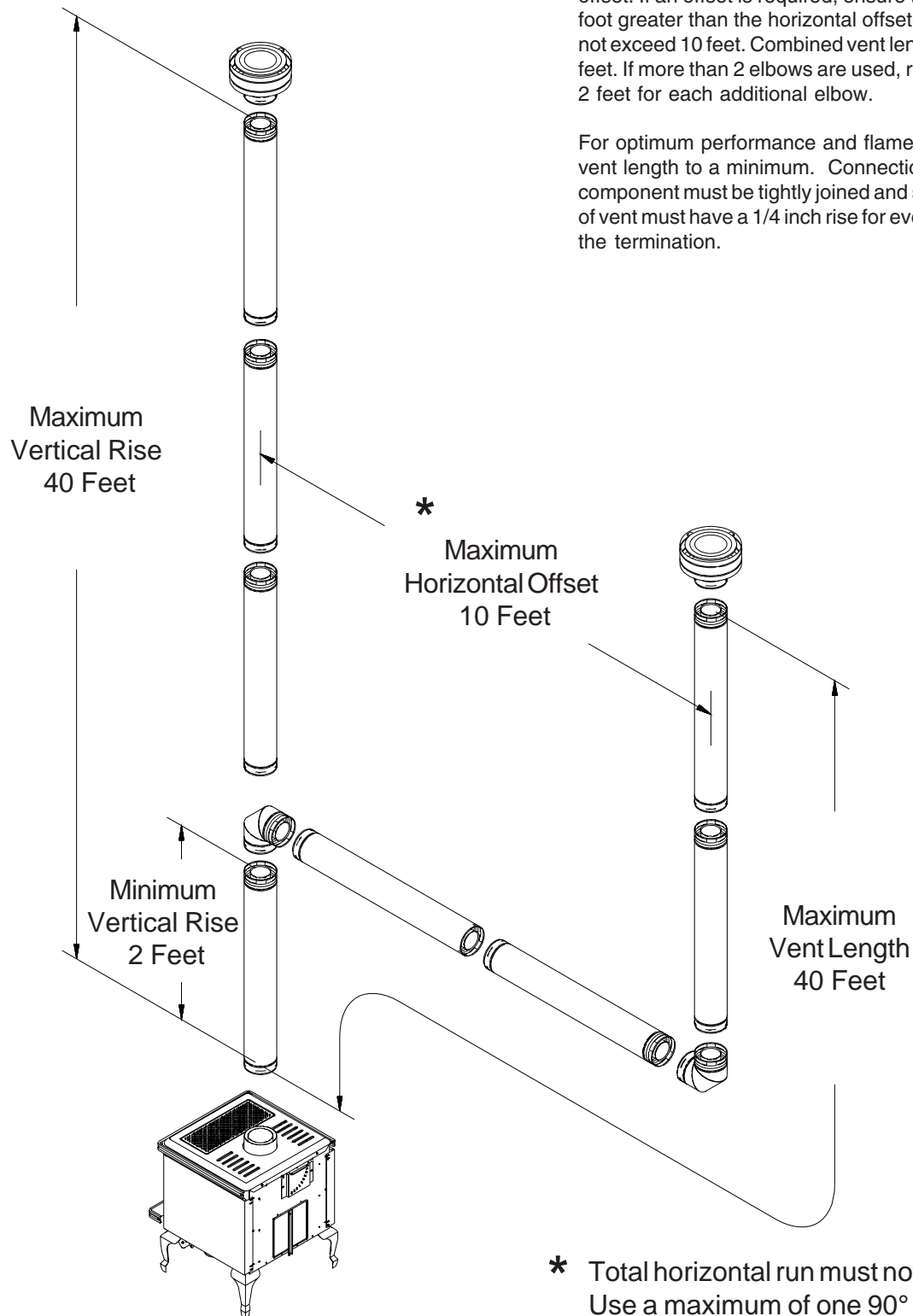

VENT RESTRICTOR ADJUSTMENT

A vent restrictor damper is built into the appliance to adjust the flow rate of exhaust gases. This ensures proper flames for the wide variety of vent configurations.

Refer to the chart for the correct damper angle for the amount of vent in your installation. Adjust the restrictor damper control on the back of the unit by moving the control rod to the appropriate index hole. Restrictor positions are based upon lab tests. The ideal position may vary slightly with installation. If necessary, adjust damper position as follows:

Damper position correction:

The damper position is correct if the rear right flame has the following characteristics:

- flame has yellow colour and some movement
- flame is vertical

Damper has too much angle if the rear right flame has the following characteristics:

- flame is pale, blue, lifting, clear, or non existent
- flame has no movement

Damper has too little angle if the rear right flame has the following characteristics:

- flame is bent forward
- flame has excessive movement

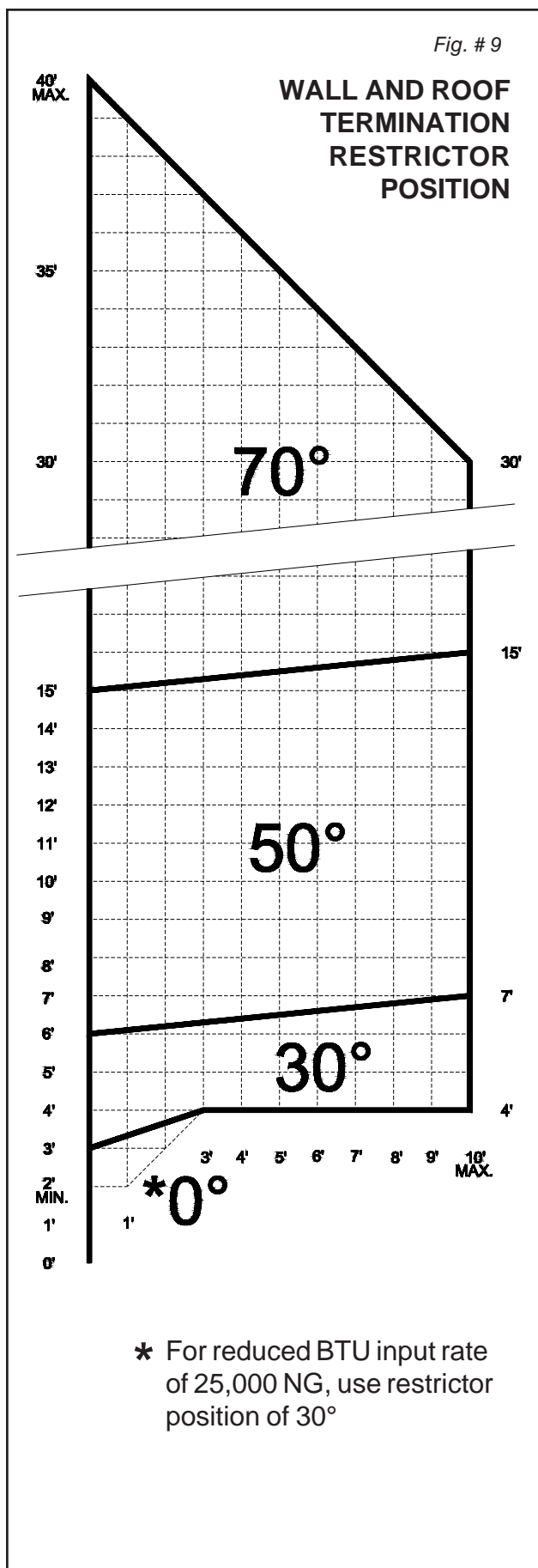
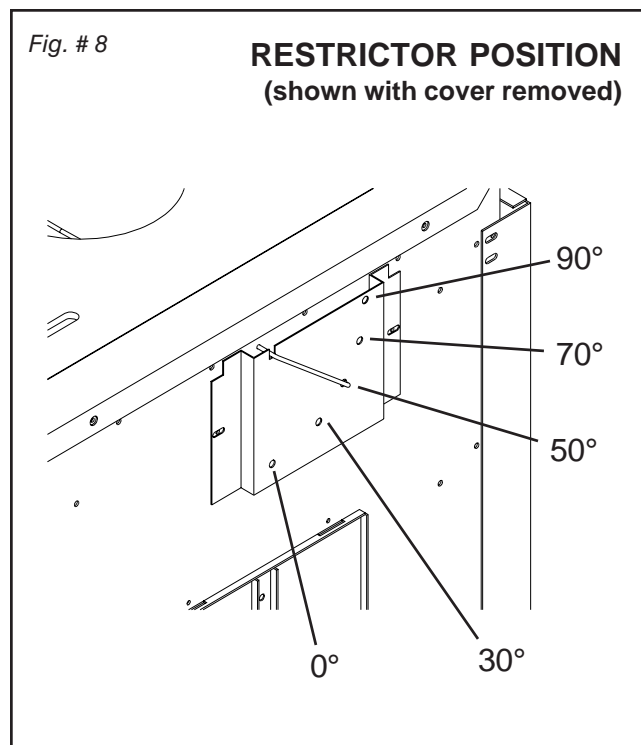

VENT TERMINAL CLEARANCES

Minimum clearances to the vent terminal must be maintained as shown in figures #10 and #11. Measure clearances to the nearest edge of termination hood.

NOTE: Vent terminal must not be recessed into a wall or siding. Follow vent terminal manufacturers installation instructions.

NOTE: LOCAL CODES OR REGULATIONS MAY REQUIRE DIFFERENT CLEARANCES.

- a = clearances above the roof line [in USA 12 inches (30 cm) minimum] [in Canada 24 inches (610 cm) minimum]
b = clearance to an adjacent wall [24 inches (610 cm) minimum]

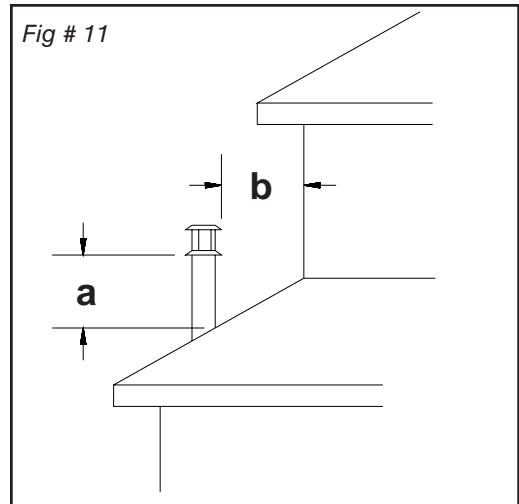
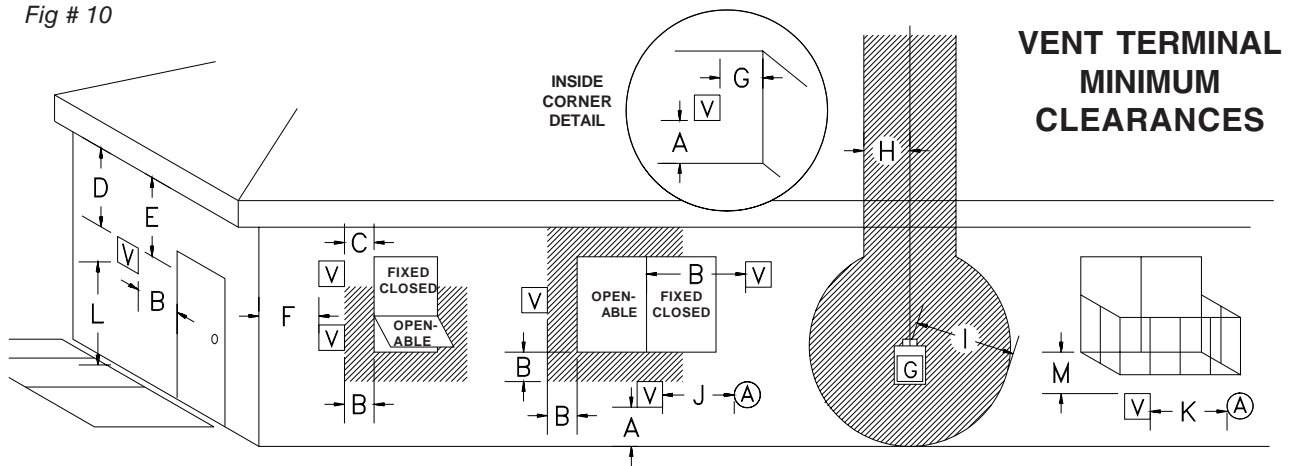

Fig # 10



VENT TERMINAL MINIMUM CLEARANCES

V VENT TERMINAL

A AIR SUPPLY INLET

AREA WHERE TERMINAL IS NOT PERMITTED

G GAS METER

| | Canadian Installation ¹ | American Installation ² | Clearance Description |
|---|---|--|---|
| A | 12" (30 cm) | | Above grade, verandah, porch, deck, or balcony. |
| B | 12" (30 cm) | 9" (23 cm) | From window or door that may be opened. |
| C | 12" (30 cm)* | | From permanently closed window (condensation). |
| D | 24" (60 cm)* | | To ventilated soffit located above the terminal, within a horizontal distance of 2' (60 cm) from center-line of terminal. |
| E | 18" (45 cm)* | | To unventilated soffit. |
| F | 12" (30 cm)* | | To outside corner. |
| G | 12" (30 cm)* | | To inside corner. |
| H | 3' (91 cm) within height of 15' (4.5 m) above meter/regulator | 3' (91 cm) within height of 15' (4.5 m) above meter/regulator* | To each side of center-line extended above a meter/regulator assembly. |
| I | 3' (91 cm) within height of | 3' (91 cm)* | Around service regulator vent outlet. |
| J | 12" (30 cm) | 9" (23 cm) | To non-mechanical air supply inlet to building, or the combustion air inlet to any other appliance. |
| K | 6' (1.83 m) | 3' (91 cm) above if within 10' (3 m) horizontally | To mechanical air supply inlet. |
| L | 7' (2.13 m) [†] | 7' (2.13 m) [†] | Above public paved sidewalk/driveway. |
| M | 12" (30 cm) ⁺ | 12" (30 cm) ⁺⁺ | Under verandah, porch, deck, or balcony. |
| N | 12" (30 cm)* | | To any horizontal surface, for roof terminations. |
| O | 12" (30 cm) | | Above roof line, for roof terminations. |

¹ In accordance with current CSA B149, Natural Gas & Propane Installation Code

² In accordance with current ANSI Z223.1 NFPA 54, National Fuel Gas Code

* These numbers are only estimates. Clearance in accordance with installation codes and the requirements of the gas supplier

[†] Vent shall not terminate directly above a sidewalk or paved driveway located between two single family dwellings & it serves both dwellings

⁺ Permitted only if verandah, porch, deck, or balcony is fully open on a minimum of two sides beneath the floor.

Fig. # 12

Venting System Components

Dura-Vent GS

Secure Vent

| | <u>galv.</u> | <u>black</u> | <u>galv.</u> | <u>black</u> |
|---|--------------|--------------|--------------|--------------|
| 6" Pipe Length | 908 | 908B | SV 4 L6 | SV 4 LB6 |
| 9" Pipe Length | 907 | 907B | | |
| 12" Pipe Length | 906 | 906B | SV 4 L12 | SV 4 LB12 |
| 24" Pipe Length | 904 | 904B | SV 4 L24 | SV 4 LB24 |
| 36" Pipe Length | 903 | 903B | SV 4 L36 | SV 4 LB36 |
| 48" Pipe Length | 902 | 902B | SV 4 L48 | SV 4 LB48 |
| 1 1/2" - 6" Adjustable Pipe Length | | | SV 4 LA | SV 4 LBA |
| 12" Adjustable Pipe Length | | | SV 4 LA12 | SV 4 LBA12 |
| 11" - 14 5/8" Adjustable Pipe Length | 911 | 911B | | |
| 90° Elbow | 990 | 990B | SV 4 E45 | SV 4 EB45 |
| 45° Elbow | 945 | 945B | SV 4 E90 | SV 4 EB90 |
| Termination Cap (Vertical) | | | SV 4 CGV | |
| High Wind Termination Cap (Vertical) | 991 | | | |
| Low Profile Termination Cap (Vertical) | 980 | | | |
| Extended Termination Cap (Vertical) | 930 | | | |
| Horizontal Square Termination Cap | 984 | | SV 4 CHC | |
| Snorkel Termination Cap - 36" | 981 | | SV 4 STC36 | |
| Snorkel Termination Cap - 14" | 982 | | SV 4 STC14 | |
| Vinyl Siding Standoff | 950 | | | |
| Vinyl Shield Protector | | | SV 4 VS | |
| Round Ceiling Support/Wall Thimble | 940 | | | |
| Cathedral Ceiling Support Box | 941 | | | |
| Adjustable Square Cathedral Ceiling Support | | | SV 4 CSB | |
| Collar for Square Cathedral Ceiling Support | | | SV 4 AC | |
| Decorative Black Plate (square) | | | SV 4 PF | |
| Universal Support | | | SV 4 SU | |
| Floor Support | | | SV 4 SD | |
| Roof Brace | | | SV 4 BS | |
| Ceiling Firestop | 963 | | SV 4 BF | |
| Insulated Attic Radiation Shield | | | SV 4 RSA | |
| Storm Collar | 953 | | SV 4 FC | |
| Flat Roof Flashing (c/w storm collar) | | | SV 4 F | |
| Roof Flashing 0/12 - 6/12 | 943 | | | |
| Roof Flashing 1/12 - 7/12 (c/w storm collar) | | | SV 4 FA | |
| Roof Flashing 7/12 - 12/12 | 943S | | | |
| Roof Flashing 8/12 - 12/12 (c/w storm collar) | | | SV 4 FB | |
| Wall Straps | 988 | | SV 4 BM | |
| Wall Radiation Shield | | | SV 4 RSM | |
| Wall Thimble | 942 | | | |

GLOWING EMBERS

Place glowing embers directly on the ember tray in a single layer covering the entire tray and burner. This will produce the best results.

Note: Only use embers supplied with this appliance. Use of any other materials or incorrectly placed embers may cause an incorrect flame pattern, sooting and/or delayed ignition.

Fig. # 12



INPUT RATE CONVERSION

To convert from stock natural gas Btu input rate of **41750** to reduced input of **25000**, the following procedure should be followed:

- 1) Ensure the burner, pilot and fuel supply are turned off, and the appliance has cooled.
- 2) Note logs position and carefully remove (if installed).
- 3) Remove glowing embers and save them for reuse (if installed).
- 4) Remove the screw located on the right rear of the burner tube fastening the burner tube assembly in place.
- 5) Remove the burner tube by moving it to the right and up. Note the location of the air shutter adjustment rod and where it passes through the burner plate.
- 6) Using a 1/2" wrench, remove the 41750 Btu orifice, (marked #31) and replace it with a 25000 Btu orifice, (marked #43). Apply a small amount of pipe joint compound to the orifice threads to ensure a good seal into the manifold.
- 7) Install the burner tube assembly in the reverse order of removal, making sure to guide the air shutter adjusting rod through the hole in the burner plate as the venturi tube is lowered onto the orifice.

Fig. # 13



Burner attachment screw

Fig. # 13a



Fig. # 13b



Fig. # 13c



Air Shutter Adjustment
Rod Access Hole

Fig. # 13d



PROPANE CONVERSION

The appliance can be converted to Propane Gas by changing the burner orifice and pilot orifice and converting the valve. To convert, proceed as follows:

Burner Orifice (see INPUT RATE CONVERSION section)

- 1) Ensure the burner, pilot and fuel supply are turned off, and the appliance has cooled.
- 2) Note logs position and carefully remove (if installed).
- 3) Remove glowing embers and save them for reuse (if installed).
- 4) Remove the screw located on the right rear of the burner tube fastening the burner tube assembly in place.
- 5) Remove the burner tube by moving it to the right and up. Note the location of the air shutter adjustment rod and where it passes through the burner plate.
- 6) Using a 1/2" wrench, remove the 41750 Btu orifice, (marked #31) and replace it with a 32000 Btu orifice, (marked #52). Apply a small amount of pipe joint compound to the orifice threads to ensure a good seal into the manifold.

Pilot Orifice

- 1) Remove the rear air deflector,
- 2) Pull the pilot hood assembly up to gain access to the orifice.
- 3) Remove the orifice with a 5/32" (4 mm) hex key and replace it with the one supplied with the kit. (Natural gas orifice marked #62; Propane orifice marked #35.)
- 4) Reinstall the rear air deflector utilizing the center attachment hole.
- 7) Install the burner tube assembly in the reverse order of removal, making sure to guide the air shutter adjusting rod through the hole in the burner plate as the venturi tube is lowered onto the orifice.

Valve Conversion

Following the installation instructions for the 820 NOVA HI/LO Conversion kit, Remove the HI/LO pressure regulator and replace with parts supplied.

- 1) Open control door to access control panel.
- 2) Pull both control knob extensions off.
- 3) Remove the two screws at the top edge of the control panel and remove panel to gain access to the adjustment rod. Depressing the igniter while moving the control panel may be necessary on units with the pedestal option.
- 4) Remove and replace the HI/LO pressure regulator supplied in the kit. Follow the installation instructions enclosed with the HI/LO pressure regulator (820 NOVA HI/LO Conversion kit).
- 5) Reassemble control panel.

Fig. # 14a

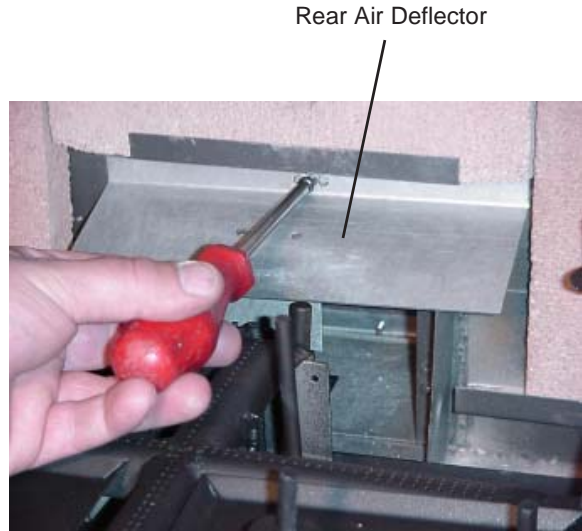

Fig. # 14b



Fig. # 14c



LOG SET

Note: Embers should be in place prior to installing logs.

Unpack and inspect log set. There should be a total of 6 logs. Gas and vent connections should be made before installing log set. All logs are numbered on the underside for their order of assembly. Handle logs carefully as they are very fragile.

Position the logs as indicated by pictures below.

Note: Improper placement of logs may cause sooting on internal parts and glass.

Step 1

Left Log Placement (log #1)



Step 2

Mid-right Log Placement (log #2)



Step 3

Mid-left Log Placement (log #3)



Step 4

Right Log Placement (log #4)



Step 5

Left Twig Placement (log #5)



Step 6

Right Twig Placement (log #6)

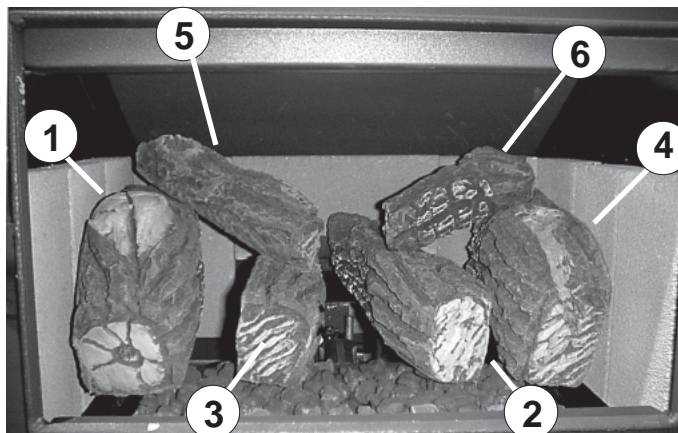

LIGHTING INSTRUCTIONS

FOR YOUR SAFETY READ BEFORE LIGHTING

WARNING: If you do not follow these instructions exactly, a fire or explosion may result causing property damage, personal injury or loss of life.

A. This appliance has a pilot which must be lighted by hand. When lighting the pilot, follow these instructions exactly.

B. **BEFORE LIGHTING** smell all around the appliance area for gas. Be sure to smell next to the floor because some gas is heavier than air and will settle on the floor.

WHAT TO DO IF YOU SMELL GAS:

- Do not try to light any appliance.
- Do not touch any electric switch; do not use any

phone in your building.

- Immediately call your gas supplier from a neighbour's phone. Follow the gas supplier's instructions.

- If you cannot reach your gas supplier, call the fire department.

C. Use only your hand to push in or turn the gas control knob. Never use tools. If the knob will not push in or turn by hand, don't try to repair it, call a qualified service technician. Force or attempted repair may result in a fire or explosion.

D. Do not use this appliance if any part has been under water. Immediately call a qualified service technician to inspect the appliance & to replace any part of the control system & any gas control which has been under water.

LIGHTING INSTRUCTIONS

1. **STOP!** Read the safety information above on this label.
2. Set wall thermostat to lowest setting, if applicable.
3. Turn off all electric power to the appliance.
4. Open the bottom grill to access the controls.
5. Partially depress and turn gas control knob clockwise ↻ past "Pilot" to "Off" position.

Note: Knob cannot be turned from "Pilot" to "Off" unless knob is pushed in slightly. Do not force.

GAS KNOB

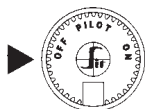

6. Allow sufficient length of time (minimum 5 minutes) for any gas in the combustion chamber to escape. If you still smell gas, **STOP!** Follow "B" in the safety information above on this label. If you don't smell gas, go to the next step.
7. Turn gas control knob back to "Pilot" position.
8. Depress gas control knob fully and hold while

you ignite pilot with the push button igniter.

Once the pilot ignites, continue depressing knob for approximately 5 seconds. If pilot does not stay lit, repeat steps 6 through 8, allowing a longer period before releasing gas control dial.

- If gas control knob does not pop up when released, stop and immediately call your service technician or gas supplier.

- If the pilot will not stay lit after several tries, turn the gas control knob to "Off" and call your service technician or gas supplier.

9. Turn gas control knob counter-clockwise ↻ to "On" position.
10. Turn HI-LO burner control knob to desired setting.
11. Close bottom grill and turn on the burner switch.
12. Turn on all electric power to the appliance.
13. Set thermostat to desired setting, if applicable.
Note: Sufficient time must be allowed for air to escape from lines if the unit is being lit for the first time.

TO TURN OFF GAS TO APPLIANCE

1. Set wall thermostat to lowest setting, if applicable.
2. Turn off all electric power to the appliance if

service is to be performed.

3. Push in gas control knob slightly and turn clockwise ↻ to "Off". Do not force.

Due to high surface temperatures, keep children, clothing and furniture away.

A cause de la température élevée des parois, tenir éloignés les enfants, les vêtements et les meubles. Keep burner and control compartment clean. See installation and operating instructions accompanying the appliance.

Maintenir propres le brûleur et le compartiment de commande. Voir les instructions relatives à l'installation et au fonctionnement qui accompagnent l'appareil.



160698

5051.1

5-INSB-1

FIRST FIRE

When lit for the first time, the appliance will emit a slight odour for a couple of hours. This is due to the curing of paints, sealants and lubricants used in the manufacturing process. This condition is temporary. Open doors and windows to ventilate area. If optional fan kit has been installed, place fan in the "OFF" position. Smoke and fumes caused by the curing process may cause discomfort to some individuals.

It is normal for fireplaces fabricated of steel to give off some expansion and/or contraction noises during the start up or cool down cycle. Similar noises are found with your furnace heat exchanger or cook stove oven.

OPERATION

The heater comes equipped with an "ON-OFF" rocker switch. This switch is conveniently located on the control panel just behind the access door.

Once a pilot light has been established, and the gas valve knob turned to the "ON" position, the burner may be turned on or off simply with the switch. An optional wall thermostat may be installed to operate the burner automatically.

Fig. # 15

Manual HI-LO Control Knob

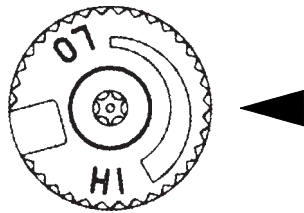

BURNER CONTROL

Manual HI-LO Flame Adjustment:

The HI-LO burner control knob can be rotated in both directions, providing infinite control of gas flow rate to the burner and therefore greater comfort control. The HI setting provides a maximum gas input (flame height), and rotating the knob clockwise toward the LO setting will reduce the gas input (flame height) to a minimum setting.

Wall Thermostat (optional part# GASC.THERMO):

Set the wall thermostat to a comfortable temperature. Turn the HI-LO burner control knob to a desired setting. As heat is required, the heater will turn on or off automatically, as needed.

Extend Shutdown:

To shutdown the appliance including the pilot, partially depress and turn gas valve knob clockwise past "PILOT" to "OFF" position. DO NOT FORCE.

NOTE: The SIT control has an interlock device which does not allow the pilot to be lit when the appliance is at operating temperature. Let the appliance cool down (approx. 60 sec.) before attempting to relight the pilot. DO NOT use force to rotate the control knob.

Fig. # 16



PRIMARY AIR ADJUSTMENT

This appliance is provided with primary air adjustment, which affects flame height and quality.

Adjustment is possible to compensate for varying field conditions, such as vent system configuration or altitude. Adjustment should be done after the appliance has reached operating temperature.

Caution! Firebox may be hot.

The air shutter adjustment rod is located behind the control panel, to the left of the gas valve, (see fig #17). Pulling the rod down opens the shutter and decreases the flame height. Pushing the rod up closes the shutter and increases the flame height.

To Adjust:

- 1) With appliance at operating temperature, open control door to access control panel.
- 2) Pull control knob extensions off.
- 3) Remove the two screws at the top edge of the control panel and remove panel to gain access to the adjustment rod. Depressing the igniter while moving the control panel may be necessary on units with the pedestal option.
- 4) Move air shutter adjustment rod up or down until proper flame is obtained.
- 5) Reassemble control panel.

Fig. # 17



Caution: Proper air shutter setting is a must.

The flame should be just yellow, "lazy" and just below the baffle. It should NEVER be set to create sooting on internal parts and glass. Open air shutter gradually until sooting stops.

OPTIONAL WALL SWITCH OR THERMOSTAT

WARNING: Do not connect electricity to the gas control valve or control wiring system of this unit.

No electrical connection is required for this system operation. The self-generating pilot provides current for the remote wall switch or wall thermostat (not provided).

The installation of a wall switch allows for manual remote operation of fireplace. Automatic operation with a wall thermostat. Use only a switch or thermostat that is millivolt rated.

Position the wall switch or thermostat so that a minimum length of wire is used from the switch to the fireplace. Use appropriate wire gauge for length of wire. Connect the wall switch to the valve as shown in figure #18.

Recommended Thermostat Wire Size

| Wire Size | Max. Length |
|-------------|-------------|
| 14 ga | 100 ft. |
| 16 ga | 60 ft. |
| 18 ga | 40 ft. |
| 20 ga | 25 ft. |
| 22 ga | 18 ft. |

Fig. # 18

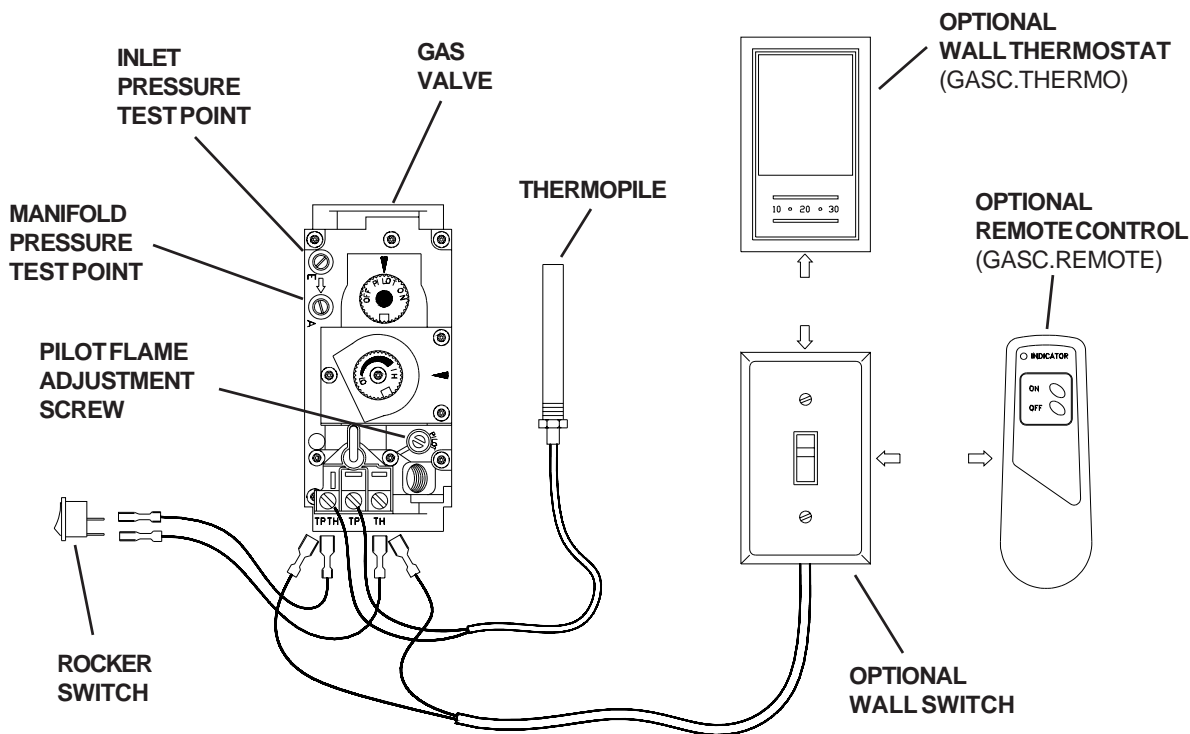

OPTIONAL BLOWER

The optional blower kit #BLOW.G1A is equipped with a three prong power cord and may be installed at any time. Follow installation instructions supplied with the kit.

Operation:

The optional circulating air blower is either thermostatically or manually controlled. Set to auto, the fan will only turn on if the appliance is at operating temperature. A few minutes after the appliance is lit and the variable speed control is set at a desired setting, the blower will automatically turn on. The blower will automatically turn off a few minutes after the appliance is shut down.

The blower may also be operated manually. Push the rocker switch to manual position and the blower will operate independent of the burner provided the variable speed control is set.

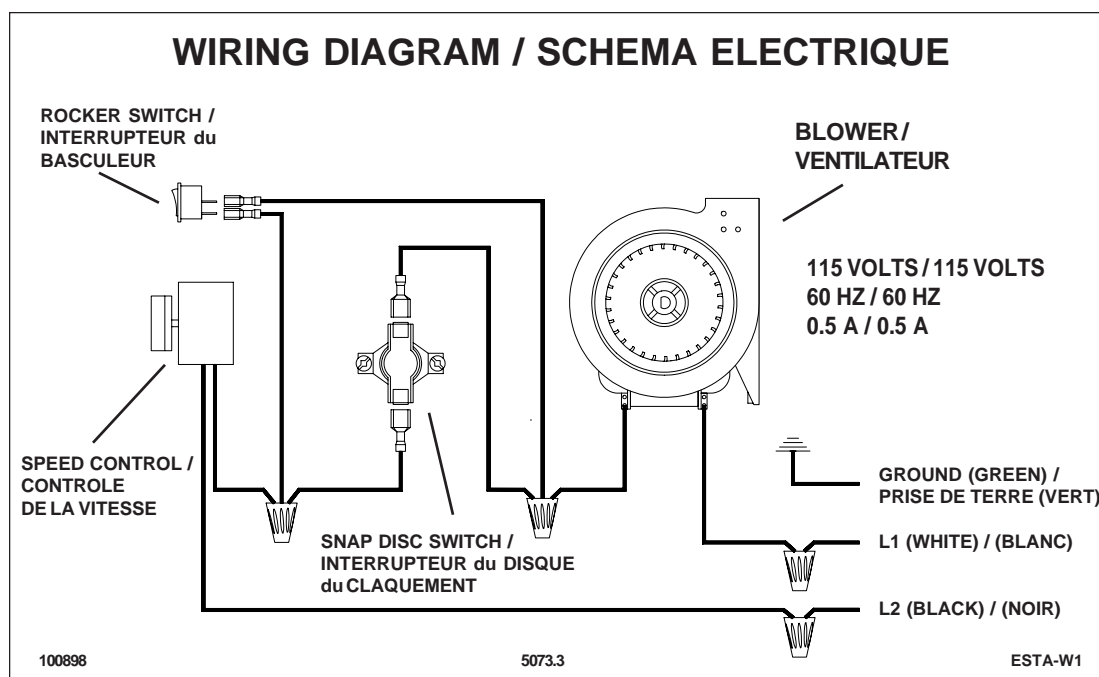
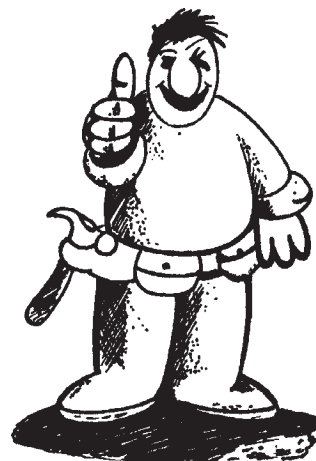

(WHEN ORDERING, INCLUDE PART NUMBER WITH DESCRIPTION)

All parts may be ordered from your nearest Pacific Energy Gas Stove dealer. Contact Pacific Energy for the location of the dealer nearest you. When ordering porcelain finish parts, please specify the appropriate colour code as follows:

Black BK
Blue BE
Green GN
Ivory IV



REPLACEMENT PARTS - Super 27 Gas

(WHEN ORDERING, INCLUDE PART NUMBER WITH DESCRIPTION)

| ITEM | DESCRIPTION | PART NO. | ITEM | DESCRIPTION | PART NO. |
|------|------------------------------|--------------|------|---------------------------------|------------|
| 1 | TOP PLATE ASSEMBLY | SUGA.7004 | 20 | CONTROL PANEL | BRNA.7043 |
| 2 | ASH LIP TRIM | 2210.5A | 21 | FIREBICK - 9" x 4 1/2" x 1 1/4" | 5096.99 |
| 3 | SIDE SHIELD PANEL | 4302 | 22 | LEG ADAPTER DOOR | LGAD.7051 |
| 4 | SIDE HEAT SHIELD | 7018 | 23 | FAN COVER ASSEMBLY | LGAD.70505 |
| 5 | ASH LIP | ALIP.2210MBA | 24 | LEG, BLACK | 5035.71 |
| 6 | DOOR CATCH LOCK | 7007 | | LEG, GOLD PLATED | 5035.71GD |
| 7 | GLASS CLAMP SET (4 PC) | SSER.142 | | LEG, NICKEL PLATED | 5035.71NI |
| 8 | GLASS BAR SET (2 PC) | WODC.4140 | 25 | LEG ADAPTER VALVE BOX | LGAD.7050 |
| 9 | REPLACEMENT GLASS (c/w TAPE) | WODC.GLKIT | 26 | PEDESTAL DOOR ASSEMBLY | SUGA.7056 |
| 10 | DOOR GASKET KIT | WODC.DGKIT | 27 | PEDESTAL WELD ASSEMBLY | SUGA.7059 |
| 11 | DOOR CASTING, BLACK | CAST.30ST | 28 | FAN COVER | 7055.5 |
| | DOOR CASTING, RADIANT BLACK | CAST.30RSST | 29 | PEDESTAL DOOR TOP ASSEMBLY | SUGA.70561 |
| | DOOR CASTING, GOLD | CAST.30GD | | LOG SET, COMPLETE (not shown) | 5098.2508 |
| | DOOR CASTING, RADIANT GOLD | CAST.30RSGD | | LOG, LEFT, #1 (not shown) | 5098.2502 |
| 12 | DOOR HANDLE ASSEMBLY | WODC.147 | | LOG, MID-RIGHT, #2 (not shown) | 5098.2503 |
| 13 | SHIELD BOTTOM FRONT | 7016 | | LOG, MID-LEFT, #3 (not shown) | 5098.2504 |
| 14 | FIREBOX SHIELD | 7014 | | LOG, RIGHT, #4 (not shown) | 5098.2505 |
| 15 | FLAME SHIELD ASSEMBLY | CLSU.7015 | | TWIG, LEFT, #5 (not shown) | 5098.2506 |
| 16 | FIREBOX TOP SHIELD | 7037 | | TWIG, RIGHT, #6 (not shown) | 5098.2507 |
| 17 | TRAY & TUBE BURNER ASSEMBLY | BRNA.7045 | | OPTIONAL BLOWER (not shown) | BLOW.G1A |
| 18 | FLUE ADAPTER GASKET | 2761 | | | |
| 19 | VENT ADAPTER | 5096.812 | | | |

All parts may be ordered from your nearest Pacific Energy dealer.
Contact Pacific Energy for the location of the dealer nearest you.

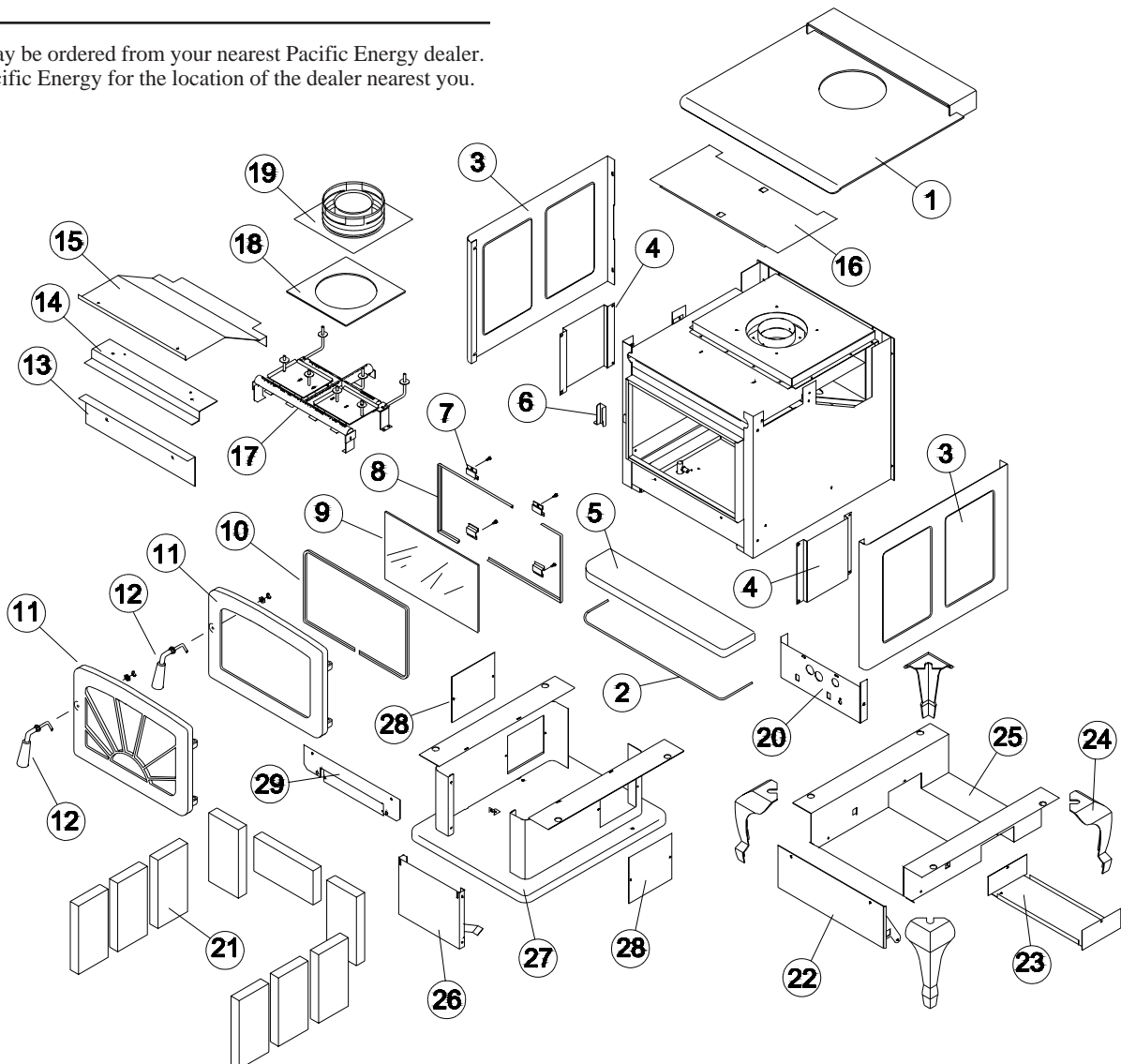

REPLACEMENT PARTS - Burner Assembly

(WHEN ORDERING, INCLUDE PART NUMBER WITH DESCRIPTION)

| ITEM | DESCRIPTION | PART NO. | ITEM | DESCRIPTION | PART NO. |
|------|--|------------|------|-----------------------------|--------------|
| 1 | GAS VALVE | 5007.05 | 11 | WASHER, FIBER | 5043 |
| 2 | EXTENSION KNOB, ON/OFF | 5007.315 | 12 | SPRING NUT | 5044 |
| 3 | EXTENSION KNOB, HI/LO | 5007.316 | 13 | SCREW, #10-32 X 3/8" | 5049.1 |
| 4 | PILOT ASSEMBLY, COMPLETE | 5009.157 | 14 | BURNER SWITCH | 5071 |
| | THERMOPILE | 5010 | 15 | BURNER GASKET | 7009 |
| | THERMOCOUPLE | 5010.3 | 16 | AIR SHUTTER ROD | 7041.5 |
| | ELECTRODE C/W WIRE | 5009.5001 | 17 | LOG PIN WASHER | 7044.5 |
| | SIT 1/8 PILOT TUBE C/W FITTINGS | 5003.0001 | 18 | BURNER BRACKET | 7048.501 |
| 5 | MANIFOLD | 5012.5 | 19 | SUPPORT BRACKET, UPPER | 7049.5 |
| 6 | IGNITER | 5016.5 | 20 | BURNER PLATE ASSEMBLY | BRNA.7040 |
| 7 | FITTING, STREET ELBOW | 5019.01 | 21 | VALVE BRACKET ASSEMBLY | BRNA.7042 |
| 8 | BURNER ORIFICE, (41,750 BTU, NG) | 5021.332.A | 22 | CONTROL PANEL | BRNA.7043 |
| | BURNER ORIFICE, (25,000 BTU, NG) | 5021.32 | 23 | EMBER TRAY ASSEMBLY | BRNA.7044 |
| | BURNER ORIFICE, (32,000 BTU, LP) | 5022.1 | 24 | BURNER TUBE ASSEMBLY | BRNA.5011817 |
| 9 | SCREW, #8 X 1/2", BLACK | 5041 | 25 | BURNER SWITCH WIRE ASSEMBLY | OXFD.50625 |
| 10 | SCREW, #8 X 1/2", PLATED | 5041.1 | | | |

BURNER ASSEMBLY Part#BRNA.7040NG

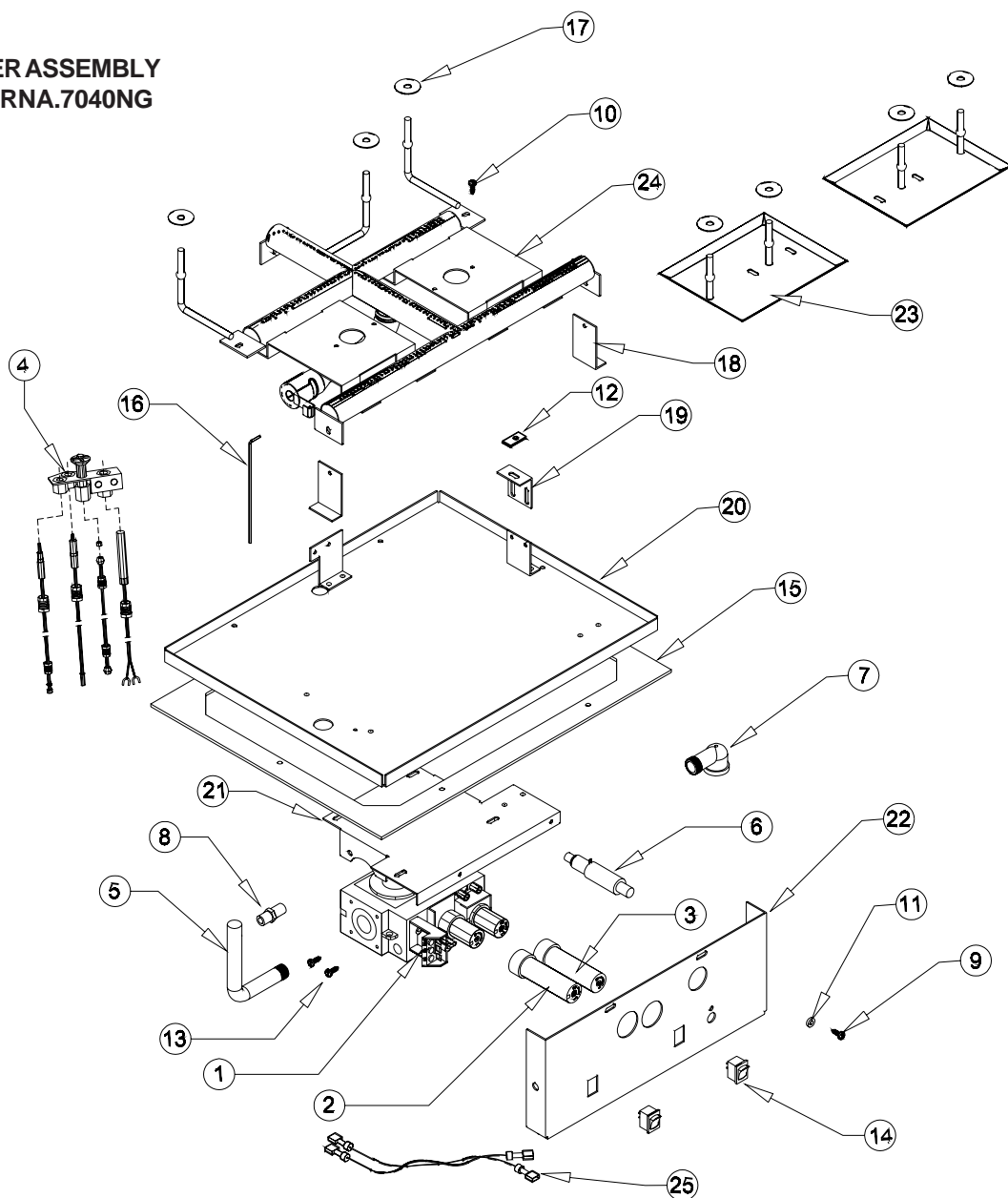

RATING LABEL

WH-



Pacific Energy Fireplace Products Ltd.
Duncan, British Columbia, Canada
Certified for Canada and U.S.A. /
Certifié pour Canada et U.S.A.



WH-

| | | | |
|---------------|---|---------------|---|
| SERIES/SERIE: | A | MODEL/MODELE: | CLASSIC GAS <input type="checkbox"/> SUPER 27 GAS <input type="checkbox"/> |
|---------------|---|---------------|---|

VENTED GAS FIREPLACE HEATER - NOT FOR USE WITH SOLID FUEL
FOYER AU GAZ À ÉVACUATION - NE PAS UTILISER AVEC DU COMBUSTIBLE SOLIDE.
ANSI Z21.88a-2003 / CAN 2.33a-2003 Vented Gas Fireplace Heaters,
CAN/CGA-2.17 -M91 Gas-Fired Appliances For Use At High Altitudes

| FOR USE WITH / EN CASE D'EMPLOI AVEC: | NATURAL GAS / DU GAZ NATUREL |
|--|--|
| Minimum supply pressure / Pression minimum d'alimentation: (For the purpose of input adjustment / dans le but de régler l'alimentation) | 5.0 in. wc / 5.0 po. c.e. (1.25 kPa) |
| Manifold pressure / Pression de la tuyauterie: | 3.8 in. wc / 3.8 po. c.e. (.95 kPa) 1.1 in. wc / 1.1 po. c.e. (.27 kPa) |
| Orifice Size / Diametre de l'injecteur: | # 31 # 43 |
| Input BTU/hr / Entree BTU/h: | Max.: 41,750 Min.: 20,875 |

Blower electrical rating: 115v, 60hz, 0.5A / Normes electriques du ventilateur: 115v, 60hz, 0.5 A.
Optional components: Fan Kit (BLOW.G1A), Propane Conversion Kit (LPKT.32KA) / Éléments facultatifs: Ventilateur
(BLOW.G1A), Trousse de conversion (LPKT.32KA).
This appliance equipped for altitudes 0 - 4500 ft. (0 - 1372 m) / Cet unite est conçu pour des altitudes variant entre 0 - 4500
pieds (0 - 1372 m). Also certified for installation in a bedroom or a bed sitting room / Aussi certifié pour installation dans une
chambre à coucher ou une salle de séjour. This appliance must be installed in accordance with local codes, if any; if none,
follow the National Fuel Gas Code, ANSI Z223.1, or Canadian Installation Codes, CAN/CGA-B149.1. Installer l'appareil
selon les codes ou règlements locaux, ou, en l'absence de tels règlements, selon les codes d'installation National Fuel
Gas Code, ANSI Z223.1 ou Canadian Installation Codes, CAN/CGA-B149.1 en vigueur.

Install in accordance with the current standard Mobile Homes, CAN/CSA Z240 MH (in CANADA), and the Manufacturer's
Home Construction and Safety Standard, Title 24 CFR, Part 3280, or the current Standard for Fire Safety Criteria for
Manufactured Home Installations, Sites, and Communities ANSI/NFPA 501A, (in the U.S.A.). Cet appareil doit être installé
conformément aux exigences de la norme CAN/CSA Z240 MH en vigueur de l'ACNOR, Installations de gaz dans les
Constructions Mobiles.

MANUFACTURED (MOBILE) HOME: This appliance is only for use with the type of gas indicated on the rating plate and may
be installed in an aftermarket, permanently located, manufactured (mobile) home where not prohibited by local codes. See
owners manual for details. This appliance is not convertible for use with other gases, unless a certified kit is used.

FABRIQUEZ (MOBILE) MAISON: Cet appareil doit être utilisé uniquement avec le type de gaz indiqué sur la plaque
signalétique et peut être installé dans une maison préfabriquée (mobile) installée à demeure si les règlements locaux le
permettent. Voir la notice du propriétaire pour plus de détails. Cet appareil ne peut être converti à d'autres gaz sauf si une
trousse de conversion certifiée est utilisée.

This vented gas fireplace heater is not for use with air filters. / Ne pas utiliser de filtre à air avec ce foyer au gaz à
évacuation.

FOR USE WITH GLASS DOORS CERTIFIED WITH THE APPLIANCE ONLY / POUR UTILISATION UNIQUEMENT AVEC LES
PORTES EN VERRE CERTIFIÉES AVEC L'APPAREIL

| MINIMUM CLEARANCES TO COMBUSTIBLES / DEGAGEMENT DES MATIERES INFLAMMABLES | | | |
|--|--|---------|--|
| Left and Right side are determined when facing the front of the appliance. / Les côtés droit et gauche se déterminent en se mettant devant l'appareil et en lui faisant face. | | | |
| Clearances to Combustibles | Regular Installation | | Alcove Installation |
| Sidewall to Appliance/Du mur lateral a l'appareil | 3 in./ 3 po. | (76 mm) | 5 in./ 5 po. (127 mm) |
| Backwall to Appliance/Du mur arriere a l'appareil | 2 in./ 2 po. | (51 mm) | 2 in./ 2 po. (51 mm) |
| Corner to Appliance/D'un coin a l'appareil | 2 in./ 2 po. | (51 mm) | N/A (N/A) |
| Alcove Size / Grandeur de l'alcove | 34 in. Wide Min. 48 in. Deep Max. 61 in. High Min. | | 34 po. Large Min. 48 po. Profond Max. 61 po. Haut Min. |

WARNING: Improper installation, adjustment, alteration, service or maintenance can cause injury or property damage.
Refer to the owner's information manual provided with this appliance. For assistance or additional information, consult a
qualified installer, service agency or the gas supplier.

AVERTISSEMENT: Une installation, un réglage, une modification, une réparation ou un entretien mal effectué peut causer
des dommages à la propriété ou des blessures. Voir la notice de l'utilisateur qui accompagne l'appareil. Pour de l'aide ou
d'autres renseignements consultez un installateur, ou un technicien agréé ou le fournisseur de gaz.

Made in Canada / Fabriqué au Canada

151104

5050.7201

1-CLGA

PROPANE CONVERSION RATING LABEL



Kit # LPKT.32KA for use with model /
Pour utilise avec du modèle:

CLASSIC GAS
SUPER 27 GAS

Series /
Serie: A



| CONVERTED TO USE / ADAPTER POUR D'EMPLOI AVEC: | LP GAS / DU GAZ LP |
|--|---|
| Minimum supply pressure / Pression minimum d'alimentation: (For the purpose of input adjustment / dans le but de régler l'alimentation) | 11.5 in. wc / 11.5 po. c.e. (2.86 kPa) |
| Manifold pressure / Pression de la tuyauterie: | 11.0 in. wc / 11.0 po. c.e. (2.74 kPa) 2.9 in. wc / 2.9 po. c.e. (.72 kPa) |
| Orifice Size / Diametre de l'injecteur: | # 52 |
| Input BTU/hr / Entree BTU/h: | Max.: 32,000 Min.: 16,000 |

This appliance was converted to PROPANE GAS with kit #LPKT.32KA on this
date by organization which accepts the responsibility that this conversion has
been properly made. / Cet appareil était converti au gaz LP par l'emploi de la
trousse de conversion (LPKT.32KA) par une organisation qui accepte la
responsabilité pour une installation en bon état.

Date: _____

By / Par: _____

161203

5052.5201

6-CLGA



CANADA'S FINEST STOVES

Pacific Energy Fireplace Products Ltd.

2975 Allenby Rd, Duncan, B.C. V9L 6V8

Phone: 250-748-1184

Web site: <http://www.pacificenergy.net>

Printed in Canada